

Terry Crow
Commissioner Precinct 1

Skeet Phillips
Commissioner Precinct 2



FOR RECORD
N CO. TEXAS

-3 PM 1:36

LAURA A. HUGHES
COUNTY CLERK

Jakie Allen
County Judge

Kelly Lane
Commissioner Precinct 3

Tommy Moore
Commissioner Precinct 4

NOTICE OF REGULAR MEETING

Notice is hereby given that a regular meeting of the Kaufman County Commissioners' Court will be held on **Tuesday, June 9, 2026, at 9:00 a.m., in the Commissioners' Court Meeting Room located in the Courthouse Annex 100 North Washington Street, Kaufman, Texas**, at which time the commissioners' court will consider the following items for discussion, and possible action, to wit:

INVOCATION:

PLEDGE OF ALLEGIANCE TO THE AMERICAN FLAG:

PLEDGE OF ALLEGIANCE TO THE TEXAS FLAG:

REMARKS FROM VISITORS; (Any member of the public that wishes to speak on an item that is on this agenda will need to sign in, complete a Public Participation Form, and present to County Clerk prior to court. Speakers will be restricted to a three-minute presentation.)

1. **ROUTINE CORRESPONDENCE**
2. **CONSENT AGENDA**
 - A. Discuss/Consider/Accept the Commissioners Court regular meeting minutes for June 2, 2026.
 - B. Discuss/Consider/Accept the Tax Assessor Collector's monthly Property Tax Collections report for April 2026.
 - C. Discuss/Consider/Accept the Tax Assessor Collector's monthly Auto Collections report for April 2026.
 - D. Discuss/Consider/Approve changing the part-time Administrative Assistant to full-time effective 6/1/26 and establishing a new Case Manager position for the remainder of FY2026.
3. **Pam Corder:** Discuss/Consider/Approve a donation to the Kaufman County Historical Commission of \$1,000.00 from Brinson Chevrolet.
4. **Kaitlyn Joyner:** Discuss/Consider/Approve a service agreement/contract with UT Southwestern for their Mobile Mammogram trailer.
5. **Shannon Roden with Development Services:** Discuss/Consider/Approve the replat of Lot 27 of Farm View Estates located on Crow Lane in Precinct 1.
6. **Shannon Roden with Development Services:** Discuss/Consider/Approve the Preliminary Replat of Ola Subdivision located on CR 106 in Precinct 1.
7. **Shannon Roden with Development Services:** Discuss/Consider/Approve the Preliminary Plat of Cory Morehead Subdivision #37 located on CR 4017 and FM 90 in Precinct 4.
8. **Jeremy Mungin:** Discuss/Consider/Approve fiber installation from Spectrum on County Road 136, County Road 137, Bradeen Dr, Crow Ln, and Anglin Way in Precinct 1.
9. **Auditor:** Discuss/Consider line item and budget transfers/corrections.
10. **Auditor:** Discuss/Consider claims for payment and/or Financial Information as provided by the County Auditor.
11. **Adjourn Meeting**

If during the meeting, a discussion of any item on the agenda should be held in a closed meeting, the Commissioners' Court will conduct a closed meeting in accordance with the Texas Open Meetings Act and the Government Code, Chapter 551, Subchapter D and E; as noted below

Attorney Consultation	Gov't Code §551.071
Real Property	Gov't Code §551.072
Contract being negotiated	Gov't Code §551.0725
Prospective gifts or donations	Gov't Code §551.073
Personnel Matters	Gov't Code §551.074
County Advisory Body deliberations	Gov't Code §551.0745
Security Devices or Security Audits and Infrastructure	Gov't Code §551.0761 and 551.089
Economic Development negotiations	Gov't Code §551.087

Before any closed meeting is convened, the presiding officer will publicly identify the section or sections of the Act authorizing the closed meeting. Should any final action, final decision, or final vote be required in the opinion of the Commissioners' Court with regards to any matter considered in such closed or executive meeting or session, then the final action, final decision, or final vote shall be either:



- (a) in the open meeting covered by the notice upon the reconvening of the public meetings; or
- (b) at a subsequent open public meeting of the Commissioners' Court upon notice thereof; as the Commissioners' Court shall determine.

Signed this the 3rd day of June, 2026.



Jackie Allen, Kaufman County Judge

I, the undersigned, County Clerk of the Kaufman County Commissioners' Court do hereby certify that the above notice of a meeting of the Kaufman County Commissioners' Court is a true and correct copy of the said notice, that I received said Notice, and it was posted on the bulletin board at the courthouse door of Kaufman County, Texas at a place readily accessible to the general public at all times on the 3rd day of June, 2026, and said notice remained so posted continuously for at least 72 hours preceding the scheduled time of the said meeting.

 Laura Hughes, County Clerk
 By: 
 Deputy: 

ANYONE WHO HAS IMPAIRMENTS REQUESTING AID AT THE COMMISSIONERS' COURT OR ANY PUBLIC MEETING MUST CALL THE COUNTY CLERK AT LEAST 72 HOURS BEFORE THE MEETING.

**COMMISSIONERS COURT
REGULAR MEETING
JUNE 2, 2026**

BE IT REMEMBERED that on this day, the Commissioners Court of Kaufman County, Texas met in a Regular Meeting in the Commissioners Court Meeting Room, Kaufman Texas with the following members present: **Jakie Allen**, County Judge; **Terry Crow** Commissioner Precinct 1; **Skeet Phillips**, Commissioner Precinct 2; **Kelly Lane**, Commissioner Precinct 3; **Tommy Moore**, Commissioner Precinct 4; **Laura Hughes**, County Clerk.

INVOCATION;

PLEDGE OF ALLEGIANCE TO THE AMERICAN FLAG;

PLEDGE OF ALLEGIANCE TO THE TEXAS FLAG;

REMARKS FROM VISITORS;

CONSENT AGENDA

2. There came on to be a motion to accept the Consent Agenda.

A. Accept Commissioners Court Meeting Minutes for May 26, 2026.

Motion was made by Commissioner Skeet Phillip and seconded by Commissioner Terry Crow.

Motion was put to a vote. Motion carried and is so ordered.

MOTION TO APPROVE PLAT

3. There came on to be a motion to approve the Final Plat for Leroy's Landing, located on CR 4072 in Precinct 4.

Motion was made by Commissioner Tommy Moore and seconded by Commissioner Kelly Lane.

Motion was put to a vote. Motion carried and is so ordered.

MOTION TO APPROVE TEMPORARY POSITION

4. There came on to be a motion to approve hiring a temporary employee in the Indigent Healthcare Department.

Motion was made by Commissioner Kelly Lane and seconded by Commissioner Terry Crow.

Motion was put to a vote. Motion carried and is so ordered.

MOTION TO APPROVE BID

5. There came on to be a motion to approve renewal of Bid 24-07 Roadside Mowing and Tree Trimming Services.

Motion was made by Commissioner Tommy Moore and seconded by Commissioner Skeet Phillip.

Motion was put to a vote. Motion carried and is so ordered.

MOTION TO APPROVE TEMPORARY ROAD CLOSURE

6. There came on to be a motion to approve temporarily closing a portion of County Road 4031 for a 90-day bridge construction project.

Motion was made by Commissioner Tommy Moore and seconded by Commissioner Kelly Lane.

Motion was put to a vote. Motion carried and is so ordered.

MOTION TO APPROVE LINE-ITEM AND BUDGET TRANSFERS/CORRECTIONS

7. There came on to be a motion to approve Line-Item and Budget Transfers/Corrections.

Motion was made by Commissioner Skeet Phillip and seconded by Commissioner Terry Crow.

Motion was put to a vote. Motion carried and is so ordered.

MOTION TO APPROVE CLAIMS FOR PAYMENT

8. There came on to be a motion to approve Claims for Payment and Financial Information, as provided by County Auditor

Motion was made by Commissioner Tommy Moore and seconded by Commissioner Kelly Lane.

Motion was put to a vote. Motion carried and is so ordered.

MOTION TO ADJOURN

9. There came on to be a motion to adjourn.

Motion was made by Commissioner Skeet Phillip and seconded by Commissioner Kelly Lane.

Motion was put to a vote. Motion carried and is so ordered.

I, Laura Hughes, County Clerk of Kaufman County, Texas, do hereby certify that the above Commissioner Court Minutes are true and correct record of the proceedings from the Commissioners Court Meeting.

ATTEST:

Laura A. Hughes

Laura Hughes, County Clerk

KAUFMAN COUNTY COMMISSIONERS' COURT AGENDA REQUEST FORM

Note: This form is required for agenda requests, with the exception of supporting materials or attachments. Forms should be returned to the County Judge's Office by email to Ashley.kirby@kaufmancounty.net and Kasey.hovis@kaufmancounty.net at the Justice Center located at 1902 US Hwy. 175, Kaufman, Texas, 75142 for inclusion on the court's agenda. Items will not be included if submitted after the deadline which is **Tuesday at 12:00 P.M (Noon)** preceding the court meeting. Items will also be omitted if no supporting documents are included with your request. Regular court meetings are held each Tuesday of the month.

COURT DATE REQUESTED: 6/9/26	SUBMITTED BY: Bianca Antuna DEPARTMENT: Tax Office	PERSON PRESENTING: Teresa Floyd
--	---	---

ITEM REQUESTED IS FOR:

- Consent Agenda
- Action/Consideration
- Discussion/Report
- Executive Session
- Public Workshop

ITEM: (PLEASE STATE EXACTLY AS YOU WANT TO APPEAR ON THE AGENDA)

Teresa Floyd; Present/Accept the Tax Assessor Collector's monthly Property Tax Collections report for April 2026
Teresa Floyd; Present/Accept the Tax Assessor Collector's monthly Auto Collections report for April 2026

APRIL 2026

KAUFMAN COUNTY

CURRENT	\$679,630.60
DELINQUENT	\$119,111.64
TOTAL COLLECTED	\$798,742.24
DEFERRAL (UNPAID)	\$178,312.28

ROAD & BRIDGE

CURRENT	\$159,465.21
DELINQUENT	\$28,431.00
TOTAL COLLECTED	\$187,896.21
DEFERRAL (UNPAID)	\$37,216.52

TOTAL TRANSACTIONS FOR THE MONTH
3,775

ROLLBACK

	Acres
PRECINCT 1	98.013
PRECINCT 2	0
PRECINCT 3	0
PRECINCT 4	0
TOTAL ACRES	98.013

KAUFMAN COUNTY 2025-2026

APRIL 2026

	CURRENT ROLL			DELINQUENT ROLL	
	M&O	I&S	%	2024 AND OLDER AMOUNT	%
GENERAL FUND					
Adjusted Tax Levy Roll	\$76,784,458.25	\$15,690,531.89	100.00%	\$3,334,785.22	100.00%
Amount to be collected	\$3,145,763.14	\$642,818.55	3.81%	\$2,370,510.83	71.08%
Amount collected this month	\$564,306.49	\$115,324.11		\$119,111.64	
Taxes collected year to date	\$73,638,695.11	\$15,056,208.22	96.19%	\$964,274.39	28.92%
Penalty & Interest collected	\$193,989.71	\$39,637.72		\$263,734.29	
SIT Overage	\$24,194.36	\$0.00		\$0.00	
Appraisal Rendition Commission	\$3,971.31	\$0.00		\$37.11	
TOTAL COLLECTIONS YEAR TO DATE	\$73,852,907.87	\$15,095,845.94		\$1,227,971.57	
TOTAL M&O AND I&S COLLECTIONS YTD	\$88,948,753.81				
Rollback Taxes collected this month	\$6,030.97				
Rollback Taxes collected year to date	\$96,622.93				
Attorney Fees collected	\$17,789.67			\$211,807.32	

KAUFMAN COUNTY ROAD & BRIDGE 2025-2026

APRIL 2026

	CURRENT ROLL			DELINQUENT ROLL	
	AMOUNT	%	2024 AND OLDER AMOUNT	%	
GENERAL FUND					
Adjusted Tax Levy Roll	\$21,990,114.26	100.00%	\$739,957.88	100.00%	
Amount to be collected	\$883,268.38	3.74%	\$512,126.77	69.21%	
Amount collected this month	\$159,465.21		\$28,431.00		
Taxes collected year to date	\$21,106,845.88	96.26%	\$227,831.11	30.79%	
Penalty & Interest collected	\$55,682.91		\$61,081.30		
SIT Overage	\$5,832.70		\$0.00		
Appraisal Rendition Commission	\$957.51		\$9.05		
TOTAL COLLECTIONS YEAR TO DATE	\$21,167,403.98		\$288,903.36		
Rollback Taxes collected this month	\$1,386.86				
Rollback Taxes collected year to date	\$21,424.72				
Attorney Fees collected	\$4,287.99		\$50,656.58		

KAUFMAN COUNTY 2024-2025

April 2025

	CURRENT ROLL		DELINQUENT ROLL	
	M&O	M&S	AMOUNT	%
GENERAL FUND				
Adjusted Tax Levy Roll	\$70,788,683.08	\$13,424,757.39	\$3,029,937.89	100.00%
Amount to be collected	\$2,864,052.21	\$543,155.77	\$2,296,344.54	75.79%
Amount collected this month	\$543,988.27	\$103,192.70	\$236,174.57	
Taxes collected year to date	\$67,925,140.87	\$12,886,289.89	\$736,163.35	24.30%
Penalty & Interest collected	\$176,398.20	\$33,452.77	\$185,733.86	
SIT Overage	\$6,672.20	\$0.00	\$0.00	
Appraisal Rendition Commission	\$2,389.64	\$0.00	\$100.27	
TOTAL COLLECTIONS YEAR TO DATE	\$68,105,821.63	\$12,919,742.66	\$921,796.94	
TOTAL M&O AND M&S COLLECTIONS YTD	\$81,025,564.29			
Rollback Taxes collected this month	\$36,405.92			
Rollback Taxes collected year to date	\$98,902.03			
Attorney Fees collected	\$16,734.69		\$164,017.85	

KAUFMAN COUNTY ROAD & BRIDGE 2024-2025

April 2025

	CURRENT ROLL		DELINQUENT ROLL	
	AMOUNT	%	AMOUNT	%
GENERAL FUND				
Adjusted Tax Levy Roll	\$20,517,582.60	100.00%	\$649,769.81	100.00%
Amount to be collected	\$813,114.30	3.96%	\$481,693.53	74.13%
Amount collected this month	\$157,393.63		\$53,678.58	
Taxes collected year to date	\$19,704,468.30	96.04%	\$168,076.28	25.87%
Penalty & Interest collected	\$51,357.25		\$42,212.02	
SIT Overage	\$1,654.95		\$0.00	
Appraisal Rendition Commission	\$592.77		\$24.55	
TOTAL COLLECTIONS YEAR TO DATE	\$19,756,887.73		\$210,263.75	
Rollback Taxes collected this month	\$7,904.66			
Rollback Taxes collected year to date	\$21,419.77			
Attorney Fees collected	\$4,147.50		\$38,357.88	

STATE OF TEXAS

*

COUNTY OF KAUFMAN

*

*

AFFIDAVIT

RE: Kaufman County

I, the undersigned authority, TERESSA FLOYD, TAX ASSESSOR of Kaufman County, Texas, who being duly sworn do certify and say that to the best of my knowledge and belief that the attached exhibit is a true and correct report of all monies collected by this office for the period April 1, 2026, to April 30, 2026, as required by Title 1, Subtitle B, Chapter 6 of the Texas Property Tax Code.

Certified to on this the 6th May 2026.

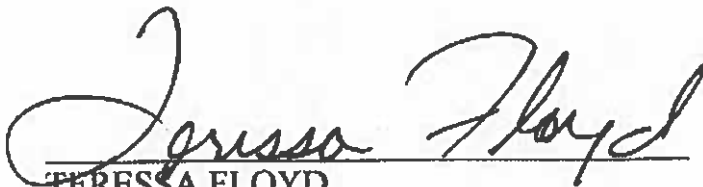

TERESSA FLOYD
TAX ASSESSOR-COLLECTOR
KAUFMAN COUNTY

TAX COLLECTION SYSTEM
 TAX COLLECTOR MONTHLY REPORT
 FROM 04/01/2026 TO 04/30/2026

FISCAL START: 10/01/2025 END: 09/30/2026 JURISDICTION: C001 KAUFMAN COUNTY

CERT TAXABLE VALUE	ADJUSTMENTS	ADJ TAX VALUE	TAX RATE	TAX LEVY	PRIOR ACCTS
28,173,036,748	113,365,360	28,286,402,108	00.234478	92,474,590.14	98,686

YEAR	TAXES DUE	MONTH ADJ	ADJUSTMENT YTD	LEVY PAID	PAID YTD	BALANCE COLL Y	YTD UNCOLL
2025	92,243,704.13	22,664.07-	231,256.01	619,595.81	88,686,408.45	3,788,581.69	0.00
2024	1,419,142.04	1,739.26-	42,494.46-	55,087.73	519,336.81	857,320.77	37.72
2023	705,757.08	1,180.70-	6,116.55-	19,558.03	220,142.93	479,492.60	31.47
2022	344,760.89	1,298.69-	18,585.41	10,302.95	107,909.47	255,435.83	29.70
2021	210,882.42	62.16-	13,735.28	2,803.74	71,603.30	153,008.43	31.88
2020	127,732.02	14.05-	174.76	904.65	16,223.73	111,683.45	12.68
2019	97,943.53	.00	0.00	377.28	8,056.52	29,886.91	8.23
2018	77,517.56	.00	23.80	473.23	4,352.64	13,188.72	5.61
2017	54,157.26	6.99-	17.79	440.49	4,180.59	49,993.86	7.72
2016	47,242.99	7.10-	17.59	133.60	3,420.51	43,840.07	7.24
2015	40,496.18	7.00-	6,385.23-	113.71	1,570.15	32,540.80	4.50
2014	29,827.57	.00	915.41-	131.83	1,398.94	27,513.22	4.84
2013	26,521.31	.00	3,109.59-	101.77	889.82	22,521.90	3.80
2012	24,881.37	.00	1,879.92-	6.78	1,170.84	21,830.61	5.09
2011	24,717.25	.00	2,073.59-	8.98	1,534.79	21,108.87	6.78
2010	24,567.51	.00	1,337.17-	0.00	1,145.35	22,084.99	4.93
2009	23,079.99	.00	1,381.28-	0.00	686.79	21,011.92	3.17
2008	21,887.43	.00	932.36-	0.00	155.15	20,599.92	.75
2007	22,979.84	.00	764.72-	1.89	193.05	22,022.07	.87
2006	22,897.71	.00	368.97-	0.00	96.95	22,431.79	.43
2005	16,289.20	.00	2,862.46-	0.00	92.65	13,114.09	.69
2004	8,136.53	.00	0.00	0.00	89.25	8,107.28	1.09
****	95,614,956.54	26,980.02-	193,227.43	709,845.54	89,650,664.48	6,157,514.79	12,091.28-
CURR	92,243,704.13	22,664.07-	231,256.01	619,595.81	88,686,408.45	3,788,581.69	0.00
DELO	3,371,252.71	4,315.95-	38,058.58-	90,249.73	964,256.03	2,368,938.10	12,691.28-

05/06/2026 13:11:52
 WC295-D
 LOCATION: AJJ
 RECEIPT DATE: ALL
 DEPOSIT
 SELECTION: DEPOSIT

5143254
 TAX COLLECTION SYSTEM
 DEPOSIT DISTRIBUTION
 FROM: 04/01/2026 THRU 04/30/2026
 JURISDICTION: 0601 KAJFMAN COUNTY

INCLUDES AS ROLLBACK

PAGE: 1

YEAR	FUNC	TAX RATE	LEVY PAID	DISCOUNT GIVEN	PENALTY INTEREST	TIF AMOUNT	DISBURSE TOTAL	ATTORNEY	OTHER FEES	REFUND AMOUNT	PAYMENT AMOUNT
2025	M & O	.27726	514,467.18	.00	49,494.25	.00	544,361.46	7,546.76	.00	.00	571,918.16
	I & S	.05672	155,228.63	.00	10,195.48	.00	115,324.12	.00	.00	.00	115,324.12
	TOTAL	.33398	619,595.81	.00	60,389.76	.00	679,685.57	7,546.76	.00	.00	687,242.27
2024	M & O	.27950	45,303.57	.00	11,389.88	.00	57,693.45	13,297.56	.00	.00	69,991.01
	I & S	.05323	8,781.22	.00	3,160.05	.00	10,941.27	.00	.00	.00	10,941.27
	TOTAL	.33273	55,084.79	.00	15,549.93	.00	68,634.72	13,297.56	.00	.00	80,932.28
2023	M & O	.27950	16,452.86	.00	6,184.69	.00	22,637.55	6,018.11	.00	.00	28,655.66
	I & S	.049368	2,905.17	.00	1,092.04	.00	3,997.21	.00	.00	.00	3,997.21
	TOTAL	.328868	19,358.03	.00	7,276.73	.00	26,634.76	6,018.11	.00	.00	32,652.87
2022	M & O	.27922	8,320.21	.00	3,203.99	.00	11,604.20	3,123.10	.00	.00	14,727.30
	I & S	.066558	1,982.75	.00	782.59	.00	2,765.34	.00	.00	.00	2,765.34
	TOTAL	.345779	10,302.96	.00	4,086.58	.00	14,369.54	3,123.10	.00	.00	17,492.64
2021	M & O	.311068	2,129.25	.00	1,056.67	.00	3,351.87	746.34	.00	.00	4,078.21
	I & S	.06827	508.49	.00	234.11	.00	742.60	.00	.00	.00	742.60
	TOTAL	.379338	2,803.72	.00	1,290.78	.00	4,094.47	746.34	.00	.00	4,870.81
2020	M & O	.34621	753.19	.00	572.05	.00	1,325.24	321.36	.00	.00	1,646.60
	I & S	.069784	251.46	.00	115.04	.00	266.50	.00	.00	.00	266.50
	TOTAL	.41600	904.65	.00	687.09	.00	1,591.74	321.36	.00	.00	1,913.10
2019	M & O	.37422	322.04	.00	280.19	.00	602.22	141.10	.00	.00	743.32
	I & S	.064303	55.24	.00	48.05	.00	103.29	.00	.00	.00	103.29
	TOTAL	.43852	377.28	.00	328.24	.00	705.51	141.10	.00	.00	846.61
2018	M & O	.42870	424.82	.00	412.81	.00	536.62	185.72	.00	.00	722.42
	I & S	.05000	49.42	.00	48.15	.00	97.57	.00	.00	.00	97.57
	TOTAL	.47870	473.23	.00	460.96	.00	634.19	185.72	.00	.00	819.97
2017	M & O	.43220	399.57	.00	430.72	.00	520.29	185.51	.00	.00	705.80
	I & S	.05650	50.92	.00	56.30	.00	107.22	.00	.00	.00	107.22
	TOTAL	.48870	440.49	.00	487.02	.00	627.51	185.51	.00	.00	813.02
2016	M & O	.43450	116.87	.00	143.66	.00	260.53	59.56	.00	.00	320.09
	I & S	.06220	25.73	.00	20.56	.00	37.29	.00	.00	.00	37.29
	TOTAL	.49670	133.60	.00	164.22	.00	297.82	59.56	.00	.00	357.38
2015	M & O	.43980	102.17	.00	137.92	.00	240.09	53.44	.00	.00	293.53
	I & S	.04970	11.54	.00	15.58	.00	27.12	.00	.00	.00	27.12
	TOTAL	.48950	113.71	.00	153.50	.00	267.21	53.44	.00	.00	320.65
2014	M & O	.44950	119.85	.00	176.22	.00	296.07	66.12	.00	.00	362.19
	I & S	.05240	13.98	.00	20.53	.00	34.51	.00	.00	.00	34.51
	TOTAL	.50200	133.83	.00	196.75	.00	330.58	66.12	.00	.00	396.70

05/06/2026 13:19:53 514284 TAX COLLECTION SYSTEM PAGE: 2
 TC95-D DEFECTION: DEPOSIT INCLUDES AG ROLLBACK
 FROM: 04/01/2026 THRU: 04/30/2026
 JURISDICTION: COO1 SAUFMAN COUNTY

YEAR	FUND	TAX RATE	LEVY PAID	DISCOUNT GIVEN	PENALTY INTEREST	TIF AMOUNT	DISBURSE TOTAL	ATTORNEY	OTHER FEES	DEPOSIT AMOUNT	PAYMENT AMOUNT
2013	M & O	.452000	99.09	.00	157.54	.00	256.63	54.79	.00	.00	311.42
	I & S	.030500	6.68	.00	10.63	.00	17.31	.00	.00	.00	17.31
	TOTAL	.482500	105.77	.00	168.17	.00	273.94	54.79	.00	.00	328.73
2012	M & O	.467500	6.21	.00	10.79	.00	17.11	3.67	.00	.00	20.77
	I & S	.034500	4.7	.00	8.9	.00	12.27	.00	.00	.00	12.27
	TOTAL	.502000	10.91	.00	19.69	.00	29.38	3.67	.00	.00	32.04
2011	M & O	.463500	5.24	.00	15.26	.00	23.60	5.08	.00	.00	28.68
	I & S	.035600	6.4	.00	1.17	.00	1.81	.00	.00	.00	1.81
	TOTAL	.499100	11.64	.00	16.43	.00	25.41	5.08	.00	.00	30.49
2007	M & O	.460000	1.76	.00	3.36	.00	5.12	.99	.00	.00	6.11
	I & S	.033500	1.13	.00	1.24	.00	.37	.00	.00	.00	.37
	TOTAL	.493500	2.89	.00	4.60	.00	5.49	.99	.00	.00	6.48
ALL	M & O		593,182.07	.00	74,169.97	.00	664,332.04	36,799.21	.00	.00	595,131.25
	I & S		119,563.47	.00	14,801.32	.00	134,364.79	.00	.00	.00	134,364.79
	TOTAL		712,745.54	.00	88,971.29	.00	798,696.83	36,799.21	.00	.00	729,536.04
DLC	M & O		75,714.89	.00	24,255.09	.00	99,970.58	23,242.51	.00	.00	123,213.09
	I & S		4,534.84	.00	4,605.84	.00	19,140.68	.00	.00	.00	19,140.68
	TOTAL		80,249.73	.00	28,861.53	.00	119,111.26	23,242.51	.00	.00	142,353.77
CURR	M & O		514,467.18	.00	49,894.28	.00	564,361.46	7,556.70	.00	.00	571,918.16
	I & S		107,128.63	.00	10,125.48	.00	117,254.11	.00	.00	.00	117,254.11
	TOTAL		621,595.81	.00	60,019.76	.00	681,615.57	7,556.70	.00	.00	689,172.27

TAX COLLECTION SYSTEM
 DEPOSIT DISTRIBUTION
 PENALTY & INTEREST ALLOCATION SCHEDULE
 FROM: 04/01/2026 THRU 04/30/2026
 JURISDICTION: 0001 KAUFMAN COUNTY

YEAR	GENERAL OPERATING PENALTY AMT	INTEREST AMT	INTEREST AND SINKING PENALTY AMT	INTEREST AMT	SPECIAL BOND FUND 1 PENALTY AMT	SPECIAL BOND FUND 2 PENALTY AMT	INTEREST AMT	TOTAL PEN / INT
2025	36,646.70	13,247.58	7,485.42	2,707.06				60,089.76
2024	4,947.34	6,442.54	938.31	1,221.74				13,549.93
2023	2,089.57	4,035.12	368.98	723.06				7,276.72
2022	954.30	2,329.69	227.38	555.21				4,066.58
2021	229.02	827.60	50.76	183.35				1,290.73
2020	91.09	480.96	18.53	96.71				687.09
2019	38.64	241.54	6.64	41.41				328.23
2018	50.87	361.94	5.92	42.23				460.96
2017	46.74	383.98	6.12	50.38				487.02
2016	14.02	129.64	2.01	18.55				164.22
2015	12.26	125.66	1.38	14.20				153.50
2014	14.38	161.84	1.68	18.85				196.75
2013	11.89	145.65	3.80	9.83				168.17
2012	0.75	10.04	0.06	0.74				11.59
2011	0.00	14.26	0.08	1.09				16.43
2007	0.21	3.15	0.02	0.22				3.60
***	45,148.78	79,071.19	9,116.89	5,684.43	0.00	0.00	0.00	88,951.29
DY	8,502.08	15,753.61	1,628.47	2,977.37	0.00	0.00	0.00	28,861.53

Multiple batches found for this date range.
 For Deposit Dates 04/01/2026 thru 04/30/2026
 File Type: PROPERTY TAX

TCS297F Detail

Report run on: May 6, 2026 1:13 PM

Ver. 1.3

Ass Unit	Attorney	TIP Levy	TIP Penalty/ Interest	Fees/ Refunds	Levy	Penalty/ Interest	Current Year Total	Prior Year Total	Disburse Total
I I & S M & O	\$0.00 \$7,556.70	\$0.00 \$0.00	\$0.00 \$0.00	\$0.00 \$0.00	\$105,128.63 \$514,467.18	\$10,195.48 \$49,894.28	\$115,324.11 \$564,361.46	\$0.00 \$0.00	\$115,324.11 \$564,361.46
2025	\$7,556.70	\$0.00	\$0.00	\$0.00	\$619,595.81	\$66,089.76	\$679,685.57	\$0.00	\$679,685.57
I & S M & O	\$0.00 \$12,297.56	\$0.00 \$0.00	\$0.00 \$0.00	\$0.00 \$0.00	\$8,781.22 \$46,303.57	\$2,160.05 \$11,389.88	\$0.00 \$0.00	\$10,941.27 \$57,693.45	\$10,941.27 \$57,693.45
2024	\$12,297.56	\$0.00	\$0.00	\$0.00	\$55,084.79	\$13,549.93	\$0.00	\$68,634.72	\$68,634.72
I & S M & O	\$0.00 \$6,018.11	\$0.00 \$0.00	\$0.00 \$0.00	\$0.00 \$0.00	\$2,905.17 \$16,452.86	\$1,092.04 \$6,184.69	\$0.00 \$0.00	\$3,997.21 \$22,637.55	\$3,997.21 \$22,637.55
2023	\$6,018.11	\$0.00	\$0.00	\$0.00	\$19,258.03	\$7,276.73	\$0.00	\$26,534.76	\$26,534.76
I & S M & O	\$0.00 \$3,123.10	\$0.00 \$0.00	\$0.00 \$0.00	\$0.00 \$0.00	\$1,982.75 \$8,320.21	\$782.59 \$3,283.99	\$0.00 \$0.00	\$2,765.34 \$11,604.20	\$2,765.34 \$11,604.20
2022	\$3,123.10	\$0.00	\$0.00	\$0.00	\$10,382.96	\$4,066.58	\$0.00	\$14,369.54	\$14,369.54
I & S M & O	\$0.00 \$776.34	\$0.00 \$0.00	\$0.00 \$0.00	\$0.00 \$0.00	\$508.99 \$2,296.25	\$234.11 \$1,056.62	\$0.00 \$0.00	\$742.60 \$3,351.87	\$742.60 \$3,351.87
2021	\$776.34	\$0.00	\$0.00	\$0.00	\$2,803.74	\$1,290.73	\$0.00	\$4,094.47	\$4,094.47
I & S M & O	\$0.00 \$321.36	\$0.00 \$0.00	\$0.00 \$0.00	\$0.00 \$0.00	\$151.46 \$753.19	\$115.04 \$572.05	\$0.00 \$0.00	\$266.50 \$1,325.24	\$266.50 \$1,325.24
2020	\$321.36	\$0.00	\$0.00	\$0.00	\$904.65	\$687.09	\$0.00	\$1,591.74	\$1,591.74
I & S M & O	\$0.00 \$141.10	\$0.00 \$0.00	\$0.00 \$0.00	\$0.00 \$0.00	\$55.24 \$322.04	\$48.05 \$280.18	\$0.00 \$0.00	\$103.29 \$602.22	\$103.29 \$602.22
2019	\$141.10	\$0.00	\$0.00	\$0.00	\$377.28	\$328.23	\$0.00	\$705.51	\$705.51
I & S M & O	\$0.00 \$185.78	\$0.00 \$0.00	\$0.00 \$0.00	\$0.00 \$0.00	\$49.42 \$423.81	\$48.15 \$412.81	\$0.00 \$0.00	\$97.57 \$836.62	\$97.57 \$836.62
2018	\$185.78	\$0.00	\$0.00	\$0.00	\$473.23	\$469.96	\$0.00	\$943.19	\$943.19
I & S M & O	\$0.00 \$185.51	\$0.00 \$0.00	\$0.00 \$0.00	\$0.00 \$0.00	\$50.92 \$389.57	\$56.30 \$430.72	\$0.00 \$0.00	\$107.22 \$820.29	\$107.22 \$820.29
2017	\$185.51	\$0.00	\$0.00	\$0.00	\$440.49	\$487.02	\$0.00	\$927.51	\$927.51
I & S M & O	\$0.00 \$59.56	\$0.00 \$0.00	\$0.00 \$0.00	\$0.00 \$0.00	\$16.73 \$116.87	\$20.56 \$143.66	\$0.00 \$0.00	\$37.29 \$260.53	\$37.29 \$260.53
2016	\$59.56	\$0.00	\$0.00	\$0.00	\$133.60	\$164.22	\$0.00	\$297.82	\$297.82
I & S M & O	\$0.00 \$53.44	\$0.00 \$0.00	\$0.00 \$0.00	\$0.00 \$0.00	\$11.54 \$102.17	\$15.58 \$137.92	\$0.00 \$0.00	\$27.12 \$240.09	\$27.12 \$240.09
2015	\$53.44	\$0.00	\$0.00	\$0.00	\$113.71	\$153.50	\$0.00	\$267.21	\$267.21
I & S M & O	\$0.00 \$66.12	\$0.00 \$0.00	\$0.00 \$0.00	\$0.00 \$0.00	\$13.98 \$119.85	\$28.53 \$176.22	\$0.00 \$0.00	\$42.51 \$296.87	\$42.51 \$296.87
2014	\$66.12	\$0.00	\$0.00	\$0.00	\$133.83	\$196.75	\$0.00	\$330.58	\$330.58

Multiple batches found for this date range.
 For Deposit Dates 04/01/2026 thru 04/30/2026
 File Type: PROPERTY TAX

TCS297F Detail

Report run on: May 6, 2026 1:13 PM

Ver. 1.3

Tax Unit	Attorney	TIF Levy	TIF Penalty/ Interest	Fees/ Refunds	Levy	Penalty/ Interest	Current Year Total	Prior Year Total	Disburse Total
I I & S M & O	\$0.00 \$54.79	\$0.00 \$0.00	\$0.00 \$0.00	\$0.00 \$0.00	\$6.68 \$99.89	\$10.63 \$157.54	\$0.00 \$0.00	\$17.31 \$256.63	\$17.31 \$256.63
2013 I & S M & O	\$54.79 \$0.00 \$3.67	\$0.00 \$0.00 \$0.00	\$0.00 \$0.00 \$0.00	\$0.00 \$0.00 \$0.00	\$105.77 \$0.47 \$6.31	\$168.17 \$0.80 \$10.79	\$0.00 \$0.00 \$0.00	\$273.94 \$1.27 \$17.10	\$273.94 \$1.27 \$17.10
2012 I & S M & O	\$3.67 \$0.00 \$5.08	\$0.00 \$0.00 \$0.00	\$0.00 \$0.00 \$0.00	\$0.00 \$0.00 \$0.00	\$6.78 \$0.64 \$8.34	\$11.59 \$1.17 \$15.26	\$0.00 \$0.00 \$0.00	\$18.37 \$1.81 \$23.60	\$18.37 \$1.81 \$23.60
2011 I & S M & O	\$5.08 \$0.00 \$0.99	\$0.00 \$0.00 \$0.00	\$0.00 \$0.00 \$0.00	\$0.00 \$0.00 \$0.00	\$8.98 \$0.13 \$1.76	\$16.43 \$0.24 \$3.36	\$0.00 \$0.00 \$0.00	\$25.41 \$0.37 \$5.12	\$25.41 \$0.37 \$5.12
2007	\$0.99	\$0.00	\$0.00	\$0.00	\$1.89	\$3.60	\$0.00	\$5.49	\$5.49
TCS298F	\$30,799.21	\$0.00	\$0.00	\$0.00	\$709,845.54	\$88,951.29	\$679,685.57	\$119,111.26	\$798,796.83
I & S M & O	\$0.00 \$0.00	\$0.00 \$0.00	\$0.00 \$0.00	\$0.00 \$0.00	\$0.00 \$0.00	\$0.00 (\$54.97)	\$0.00 (\$54.97)	\$0.00 \$0.00	\$0.00 (\$54.97)
2025 I & S M & O	\$0.00 \$0.00 \$0.00	\$0.00 \$0.00 \$0.00	\$0.00 \$0.00 \$0.00	\$0.00 \$0.00 \$0.00	\$0.00 \$0.00 \$0.00	(\$54.97) \$0.00 (\$0.93)	(\$54.97) \$0.00 \$0.00	\$0.00 \$0.00 (\$0.93)	(\$54.97) \$0.00 (\$0.93)
2024 I & S M & O	\$0.00 \$0.00 \$0.00	\$0.00 \$0.00 \$0.00	\$0.00 \$0.00 \$0.00	\$0.00 \$0.00 \$0.00	\$0.00 \$0.00 \$0.00	\$0.00 \$0.00 \$1.87	\$0.00 \$0.00 \$0.00	(\$0.93) \$0.00 \$1.87	(\$0.93) \$0.00 \$1.87
2023 I & S M & O	\$0.00 \$0.00 \$0.00	\$0.00 \$0.00 \$0.00	\$0.00 \$0.00 \$0.00	\$0.00 \$0.00 \$0.00	\$0.00 \$0.00 \$0.00	\$1.87 \$0.00 (\$0.56)	\$0.00 \$0.00 \$0.00	\$1.87 \$0.00 (\$0.56)	\$1.87 \$0.00 (\$0.56)
2022	\$0.00	\$0.00	\$0.00	\$0.00	\$0.00	(\$0.56)	\$0.00	(\$0.56)	(\$0.56)
TCS298X	\$0.00	\$0.00	\$0.00	\$0.00	\$0.00	(\$54.97)	(\$54.97)	\$0.38	(\$54.99)
Current Total:	\$7,556.70	\$0.00	\$0.00	\$0.00	\$619,995.81	\$60,034.79	\$679,630.60	\$0.00	\$679,630.60
Prior Year Total:	\$23,242.51	\$0.00	\$0.00	\$0.00	\$98,249.73	\$28,061.91	\$0.00	\$119,111.64	\$119,111.64
Total:	\$30,799.21	\$0.00	\$0.00	\$0.00	\$709,845.54	\$88,096.70	\$679,630.60	\$119,111.64	\$798,742.24

Jurisdiction Remittances Processed By Disbursing Tax Unit Property Tax File
For Remitted Deposit Dates 04/01/2026 thru 04/30/2026 as of 05/06/2026

Report run on: May 6, 2026 1:15 PM

5143273

Tax Unit	M & O Total	I & S Total	TIF Levy	TIF Interest	Fee Total	Batch Seq	Total
1 KAUFMAN COUNTY							
1 KAUFMAN COUNTY							
Current	260,039.58	53,145.31	0.00	0.00	0.00	313,184.89	
Delq	53,592.86	10,339.24	0.00	0.00	0.00	63,932.10	
Subtotal:	\$313,632.44	\$63,484.55	\$0.00	\$0.00	\$0.00	\$377,116.99	
9001 WASTE DISPOSAL PERMIT KAUFMAN							
Current	2,310.00	0.00	0.00	0.00	0.00	2,310.00	
Subtotal:	\$2,310.00	\$0.00	\$0.00	\$0.00	\$0.00	\$2,310.00	
9002 WASTE DISPOSAL PERMIT TERRILL							
Current	70.00	0.00	0.00	0.00	0.00	70.00	
Subtotal:	\$70.00	\$0.00	\$0.00	\$0.00	\$0.00	\$70.00	
9150 RETURNED ITEM FEE							
Current	30.00	0.00	0.00	0.00	0.00	30.00	
Subtotal:	\$30.00	\$0.00	\$0.00	\$0.00	\$0.00	\$30.00	
9180 WIRE FEE-ONLINE AUCTION							
Delq	40.00	0.00	0.00	0.00	0.00	40.00	
Subtotal:	\$40.00	\$0.00	\$0.00	\$0.00	\$0.00	\$40.00	
9500 KAUFMAN MISC FEES							
Current	440.00	0.00	0.00	0.00	0.00	440.00	
Subtotal:	\$440.00	\$0.00	\$0.00	\$0.00	\$0.00	\$440.00	
ACH 33532	\$316,522.44	\$63,484.55	\$0.00	\$0.00	\$0.00	\$380,006.99	
Print Date: 04/15/2026							

Jurisdiction Remittances Processed By Disbursing Tax Unit Property Tax File
For Remitted Deposit Dates 04/01/2026 thru 04/30/2026 as of 05/06/2026

Report run on: May 6, 2026 1:15 PM

5143273

Tax Unit	M & O Total	I & S Total	TIF Levy	TIF Interest	Fee Total	Total
1 KAUFMAN COUNTY						
1 KAUFMAN COUNTY						
Current	89,746.72	18,339.77	0.00	0.00	0.00	108,086.49
Delq	12,954.57	2,461.31	0.00	0.00	0.00	15,415.88
Subtotal:	\$102,701.29	\$20,801.08	\$0.00	\$0.00	\$0.00	\$123,502.37
9001 WASTE DISPOSAL PERMIT KAUFMAN						
Current	1,910.00	0.00	0.00	0.00	0.00	1,910.00
Subtotal:	\$1,910.00	\$0.00	\$0.00	\$0.00	\$0.00	\$1,910.00
9002 WASTE DISPOSAL PERMIT TERRELL						
Current	20.00	0.00	0.00	0.00	0.00	20.00
Subtotal:	\$20.00	\$0.00	\$0.00	\$0.00	\$0.00	\$20.00
9150 RETURNED ITEM FEE						
Current	60.00	0.00	0.00	0.00	0.00	60.00
Subtotal:	\$60.00	\$0.00	\$0.00	\$0.00	\$0.00	\$60.00
9500 KAUFMAN MISC FEES						
Current	410.00	0.00	0.00	0.00	0.00	410.00
Subtotal:	\$410.00	\$0.00	\$0.00	\$0.00	\$0.00	\$410.00
ACH 33589 Print Date: 04/22/2026	\$105,101.29	\$20,801.08	\$0.00	\$0.00	\$0.00	\$125,902.37

Jurisdiction Remittances Processed By Disbursing Tax Unit Property Tax File
For Remitted Deposit Dates 04/01/2026 thru 04/30/2026 as of 05/06/2026

Report run on: May 6, 2026 1:15 PM

Batch Seq 5143273

Tax Unit		M & O Total	I & S Total	TIF Levy	TIF Interest	Fee Total	Total
1	KAUFMAN COUNTY						
	1 KAUFMAN COUNTY						
	Current	214,520.19	43,839.03	0.00	0.00	0.00	258,359.22
	Delq	33,423.53	6,340.13	0.00	0.00	0.00	39,763.66
	Subtotal:	\$247,943.72	\$50,179.16	\$0.00	\$0.00	\$0.00	\$298,122.88
9001	WASTE DISPOSAL PERMIT KAUFMAN						
	Current	1,550.00	0.00	0.00	0.00	0.00	1,550.00
	Subtotal:	\$1,550.00	\$0.00	\$0.00	\$0.00	\$0.00	\$1,550.00
9002	WASTE DISPOSAL PERMIT TERRILL						
	Current	130.00	0.00	0.00	0.00	0.00	130.00
	Subtotal:	\$130.00	\$0.00	\$0.00	\$0.00	\$0.00	\$130.00
9004	WASTE DISPOSAL PERMIT KEMP						
	Current	50.00	0.00	0.00	0.00	0.00	50.00
	Subtotal:	\$50.00	\$0.00	\$0.00	\$0.00	\$0.00	\$50.00
9500	KAUFMAN MISC FEES						
	Current	700.00	0.00	0.00	0.00	0.00	700.00
	Subtotal:	\$700.00	\$0.00	\$0.00	\$0.00	\$0.00	\$700.00
ACH 33639	Print Date: 05/06/2026	\$250,373.72	\$50,179.16	\$0.00	\$0.00	\$0.00	\$300,552.88
	Tax Unit Subtotal:	\$671,997.45	\$134,464.79	\$0.00	\$0.00	\$0.00	\$806,462.24

KAUFMAN COUNTY

**Rendition Commission Distribution Detail
from 04/01/2026 to 04/30/2026**

Date: 05/06/2026 13:17:15

Tax Unit: 1 KAUFMAN COUNTY

Account No.	Year	Deposit	Levy Collected	Rendition Penalty	P & I Collected	Rendition P & I	Appraisal Commission	Disbursement Amount
184551	2025	04142026TA	286.82	26.98	32.65	0.00	1.35	328.12
186423	2025	041426CPCK	9.20	0.84	1.01	0.00	0.04	10.17
204427	2025	041626CPOC	47.83	4.35	5.26	0.00	0.22	52.87
225413129	2025	041326CPOC	71.74	6.52	7.89	0.00	0.33	79.30
240101129	2025	041426CPOC	18.39	1.67	2.02	0.00	0.08	20.33
73463	2025	04142026TA	174.88	32.06	19.24	0.00	1.60	192.52
184430	2025	042826CPCK	11.13	1.01	1.22	0.00	0.05	12.30
188781	2025	042826CPOC	68.09	6.01	7.27	0.00	0.30	73.06
189707	2025	04222026AR	19.13	1.74	2.10	0.00	0.09	21.14
193862129	2025	042826CPOC	23.91	2.17	2.63	0.00	0.11	26.43
196895129	2025	04212026SN	137.97	25.09	15.18	0.00	1.25	151.90
204130	2025	042126CPCK	28.44	2.88	3.24	0.00	0.13	32.55
219498129	2025	042726CPOC	23.91	2.17	2.63	0.00	0.11	26.43
220316129	2025	042926CPOC	22.81	2.07	2.51	0.00	0.10	25.22
225008129	2025	042826CPOC	1,103.77	100.34	121.41	0.00	5.02	1,220.16
225025129	2025	04212026TA	89.82	16.47	9.88	0.00	0.82	98.88
227163129	2025	042726CPOC	69.91	6.36	7.69	0.00	0.32	77.28
233071129	2025	042826CPOC	18.39	1.87	2.02	0.00	0.08	20.33
233071129	2025	042826CPCK	-18.39	-1.67	-2.02	0.00	-0.08	-20.33
233077129	2025	042426CPOC	38.80	3.35	4.05	0.00	0.17	40.68
240370129	2025	042826CPOC	28.44	2.68	3.24	0.00	0.13	32.55
240386129	2025	042726CPOC	38.80	3.35	4.05	0.00	0.17	40.68
240426129	2025	04242026SN	204.34	26.76	32.38	0.00	1.34	325.38

KAUFMAN COUNTY

**Rendition Commission Distribution Detail
from 04/01/2026 to 04/30/2026**

Date: 05/06/2026 13:17:15

1

Tax Unit Page: 2 of 3

Tax Unit: 1 KAUFMAN COUNTY

Account No.	Year	Deposit	Levy Collected	Rendition Penalty	P & I Collected	Rendition P & I	Appraisal Commission	Disbursement Amount
240426129	2025	04242026KGB	294.34	26.76	32.38	0.00	1.34	325.38
240426129	2025	04242026KGB	-294.34	-26.76	-32.38	0.00	-1.34	-325.38
240431129	2025	042726CPCC	36.23	8.36	3.99	0.00	0.42	39.80
240431129	2025	042826REVSN	-36.23	-8.36	-3.99	0.00	-0.42	-39.80
240442129	2025	04212026TA	36.80	3.35	4.05	0.00	0.17	40.68
240448129	2025	04282026TA	275.95	25.09	30.35	0.00	1.25	305.05
241599129	2025	042726CPCC1	147.17	13.38	16.19	0.00	0.67	162.69
3195328	2025	042726CPCC2	387.43	35.22	42.62	0.00	1.76	428.29
3195840	2025	04302026MB	23.91	2.17	2.63	0.00	0.11	26.43
241131129	2025	040126CPCC	38.80	3.35	3.31	0.00	0.17	39.94
235491129	2025	040126CPCC	230.87	20.99	20.78	0.00	1.05	250.60
67982	2025	040626CPCC2	73.59	6.69	8.09	0.00	0.33	81.35
68832	2025	04012026AR	108.56	9.96	12.05	0.00	0.50	121.11
78213	2025	04082026TA	70.45	6.52	7.75	0.00	0.33	77.87
185485	2025	040126CPCC	23.91	2.17	2.15	0.00	0.11	25.85
186637	2025	04082026TA	36.80	3.35	3.31	0.00	0.17	39.94
186680	2025	040126CPCC	183.96	16.72	16.56	0.00	0.84	199.68
187598	2025	040626CPCC	449.01	244.17	49.39	0.00	12.21	486.19
197653129	2025	040926CPCC	860.95	78.27	94.70	0.00	3.91	951.74
213237129	2025	040126CPCC	47.83	4.35	4.30	0.00	0.22	51.91
204233	2025	04072026TA	21.53	1.96	1.94	0.00	0.10	23.37
225117129	2025	040626CPCC	38.80	3.35	4.05	0.00	0.17	40.68
227098129	2025	04022026SN	2,930.31	266.39	263.73	0.00	13.32	3,180.72

KAUFMAN COUNTY

**Rendition Commission Distribution Detail
from 04/01/2026 to 04/30/2026**

Date: 05/06/2026 13:17:15

1

Tax Unit Page: 3 of 3

Tax Unit: 1 KAUFMAN COUNTY

Account No.	Year	Deposit	Levy Collected	Rendition Penalty	P & I Collected	Rendition P & I	Appraisal Commission	Disbursement Amount
227088129	2025	04022026SN	441.51	40.14	39.74	0.00	2.01	479.24
234207129	2025	04102026CA	78.57	36.79	8.65	0.00	1.84	85.38
Total for 2025			9,117.84	1,099.05	923.89	0.00	54.97	9,986.76

Account No.	Year	Deposit	Levy Collected	Rendition Penalty	P & I Collected	Rendition P & I	Appraisal Commission	Disbursement Amount
176446	2024	040126CPCC	85.51	7.78	22.26	0.00	0.39	107.48
3194433	2024	040826CPCC	51.79	10.81	13.98	0.00	0.54	65.23
Total for 2024			137.40	18.59	36.24	0.00	0.93	172.71

Account No.	Year	Deposit	Levy Collected	Rendition Penalty	P & I Collected	Rendition P & I	Appraisal Commission	Disbursement Amount
195026129	2023	04242026KGB	-28.37	-65.79	-11.06	0.00	-3.29	-36.14
195026129	2023	04242026SN	28.37	28.37	11.06	0.00	1.42	38.01
Total for 2023			0.00	-37.42	0.00	0.00	-1.87	1.87

Account No.	Year	Deposit	Levy Collected	Rendition Penalty	P & I Collected	Rendition P & I	Appraisal Commission	Disbursement Amount
216326129	2022	042726CPCC1	123.64	11.24	63.06	0.00	0.56	186.14
Total for 2022			123.64	11.24	63.06	0.00	0.56	186.14
Total for Tax Unit 1 KAUFMAN COUNTY			9,378.88	1,091.46	1,023.19	0.00	54.59	10,347.48

05/06/2026 13:28:3
TC168

5143286

TAX COLLECTION SYSTEM
TAX COLLECTOR MONTHLY REPORT
FROM 04/30/2026 TO 04/30/2026

INCLICES AG ROLLBACK

PAGE: 4

FISCAL START: 10/01/2025 END: 09/30/2026 JURISDICTION: 0006 WARREN COUNTY ISS ONLY

CURT TAXABLE VALUE	ADJUSTMENTS	ADJ TAX VALUE	TAX RATE	TAX LEVY	PAID ACCTS
27,459,638	24,959,419	37,428,073	00.056752	5,494.85	4

YEAR	TAXES DUE	MONTH AUC	ADJUSTMENT YTD	LEVY PAID	PAYD YTD	BALANCE COLD Y	YTD INCOML
2025	0.00	.00	2,494.88	0.00	8,494.98	0.00	0.00
****	0.00	.00	8,494.88	0.00	8,494.88	0.00	0.00
CURR	0.00	.00	8,494.88	0.00	8,494.88	0.00	0.00
DFIC	0.00	.00	0.00	0.00	0.00	0.00	0.00

04/06/2026 13:28:3 5143286

TAX COLLECTION SYSTEM
TAX COLLECTOR MONTHLY REPORT
FROM 04/01/2026 TO 04/30/2026

INCLUDES AC ROLLBACK

PAGE: 509

FISCAL START: 10/01/2025 END: 04/30/2026 JURISDICTION: 9001 WASTE DISPOSAL PERMIT KAU:MAH

CURRENT YEAR	NETT TAXABLE VALUE	ADJUSTMENTS	ADJ TAX VALUE	TAX RATE	TAX LEVY	PAYD ACCRS
	0	0	0.0	00.120000	39,420.00	94E

YEAR	TAXES DUE	MONTH ADJ	ADJUSTMENT YTD	LEVY PAID	PAYD YTD	BALANCE COL. V	YTD UNCOLL
2025	0.00	5,770.00	38,620.00	5,770.00	38,620.00	0.00	0.00
2024	100.00	.00	450.00	0.00	1,560.00	0.00	0.00
***	100.00	5,770.00	39,570.00	5,770.00	39,590.00	0.00	0.00
CURR	0.00	5,770.00	38,620.00	5,770.00	38,620.00	0.00	0.00
DETC	10.00	.00	950.00	0.00	1,560.00	0.00	0.00

05/06/2026 13:19:53 5143284
 TC298-D SELECTION: DEPOSIT
 RECEIPT DATE: ALL
 LOCATION: ALL

TAX COLLECTION SYSTEM
 DEPOSIT DISTRIBUTION
 FROM: 04/01/2026 THRU 04/30/2026

INCLUDES AC ROLLBACK

JURISDICTION: 9001 WASTE DISPOSAL PERMIT KANPMA

YEAR	FUND	TAX RATE	LEVY RATE	DISCOUNT GIVEN	PENALTY INTEREST	TIP AMOUNT	DISBURSE TOTAL	ATTORNEY FEE	OTHER FEE	REFUND AMOUNT	PAYMENT AMOUNT
2025	M & O	.120000	5,770.00	.00	.00	.00	5,770.00	.00	.00	.00	5,770.00
	I & S	.000000	.00	.00	.00	.00	.00	.00	.00	.00	.00
	TOTAL	.120000	5,770.00	.00	.00	.00	5,770.00	.00	.00	.00	5,770.00
ALL	M & O		5,770.00	.00	.00	.00	5,770.00	.00	.00	.00	5,770.00
ALL	I & S		.00	.00	.00	.00	.00	.00	.00	.00	.00
ALL	TOTAL		5,770.00	.00	.00	.00	5,770.00	.00	.00	.00	5,770.00
DLQ	M & O		.00	.00	.00	.00	.00	.00	.00	.00	.00
DLQ	I & S		.00	.00	.00	.00	.00	.00	.00	.00	.00
DLQ	TOTAL		.00	.00	.00	.00	.00	.00	.00	.00	.00
CURR	M & O		5,770.00	.00	.00	.00	5,770.00	.00	.00	.00	5,770.00
CURR	I & S		.00	.00	.00	.00	.00	.00	.00	.00	.00
CURR	TOTAL		5,770.00	.00	.00	.00	5,770.00	.00	.00	.00	5,770.00

C5706/2026 13:11:57
 20298-F SELECTION: DEPOSIT

TAX COLLECTION SYSTEM
 DEPOSIT DISTRIBUTION
 PENALTY & INTEREST ALLOCATION SCHEDULE

INCLUDES AC ROLLBACK
 PAGE: 52

FROM: 04/01/2026 THRU 04/30/2026

JURISDICTION: 9001 WASTE DISPOSAL PERMIT KAUFMAN

YEAR	GENERAL OPERATING	INTEREST AND SINKING	SPECIAL BOND FUND 1	SPECIAL BOND FUND 2	TOTAL PEN / INT
	FYALOC AMT	INTEREST AMT	FENALTY AMT	INTEREST AMT	INTEREST AMT
2025	0.00	0.00	0.00	0.00	0.00
2026	0.00	0.00	0.00	0.00	0.00
2027	0.00	0.00	0.00	0.00	0.00

Multiple batches found for this date range.
 For Deposit Dates 04/01/2026 thru 04/30/2026
 File Type: PROPERTY TAX

TCS297F Detail

Report run on: May 6, 2026 1:13 PM

Ver. 1.3

Tax Unit	Attorney	TIF Levy	TIF Penalty/ Interest	Fees/ Refunds	Levy	Penalty/ Interest	Current Year Total	Prior Year Total	Disburse Total
9001 I & S	\$0.00	\$0.00	\$0.00	\$0.00	\$0.00	\$0.00	\$0.00	\$0.00	\$0.00
M & O	\$0.00	\$0.00	\$0.00	\$0.00	\$5,770.00	\$0.00	\$5,770.00	\$0.00	\$5,770.00
2025	\$0.00	\$0.00	\$0.00	\$0.00	\$5,770.00	\$0.00	\$5,770.00	\$0.00	\$5,770.00
Current Total:	\$0.00	\$0.00	\$0.00	\$0.00	\$5,770.00	\$0.00	\$5,770.00	\$0.00	\$5,770.00
Prior Year Total:	\$0.00	\$0.00	\$0.00	\$0.00	\$0.00	\$0.00	\$0.00	\$0.00	\$0.00
Total:	\$0.00	\$0.00	\$0.00	\$0.00	\$5,770.00	\$0.00	\$5,770.00	\$0.00	\$5,770.00

APRIL 2026

KAUFMAN COUNTY

CURRENT	\$679,630.60
DELINQUENT	\$119,111.64
TOTAL COLLECTED	\$798,742.24
DEFERRAL (UNPAID)	\$178,312.28

ROAD & BRIDGE

CURRENT	\$159,465.21
DELINQUENT	\$28,431.00
TOTAL COLLECTED	\$187,896.21
DEFERAL (UNPAID)	\$37,216.52

TOTAL TRANSACTIONS FOR THE MONTH
3,775

ROLLBACK

	Acres
PRECINCT 1	98.013
PRECINCT 2	0
PRECINCT 3	0
PRECINCT 4	0
TOTAL ACRES	98.013

KAUFMAN COUNTY 2025-2026

APRIL 2026

	CURRENT ROLL			DELINQUENT ROLL	
	M&O	I&S	%	2024 AND OLDER AMOUNT	%
GENERAL FUND					
Adjusted Tax Levy Roll	\$76,784,458.25	\$15,690,531.89	100.00%	\$3,334,785.22	100.00%
Amount to be collected	\$3,145,763.14	\$642,818.55	3.81%	\$2,370,510.83	71.08%
Amount collected this month	\$564,306.49	\$115,324.11		\$119,111.64	
Taxes collected year to date	\$73,638,695.11	\$15,056,208.22	96.19%	\$964,274.39	28.92%
Penalty & Interest collected	\$193,989.71	\$39,637.72		\$263,734.29	
SIT Overage	\$24,194.36	\$0.00		\$0.00	
Appraisal Rendition Commission	\$3,971.31	\$0.00		\$37.11	
TOTAL COLLECTIONS YEAR TO DATE	\$73,852,907.87	\$15,095,845.94		\$1,227,971.57	
TOTAL M&O AND I&S COLLECTIONS YTD	\$88,948,753.81				
Rollback Taxes collected this month	\$6,030.97				
Rollback Taxes collected year to date	\$96,622.93				
Attorney Fees collected	\$17,789.67			\$211,807.32	

KAUFMAN COUNTY ROAD & BRIDGE 2025-2026

APRIL 2026

	CURRENT ROLL			DELINQUENT ROLL	
	AMOUNT	%	2024 AND OLDER AMOUNT	%	
Adjusted Tax Levy Roll	\$21,990,114.26	100.00%	\$739,957.88	100.00%	
Amount to be collected	\$883,268.38	3.74%	\$512,126.77	69.21%	
Amount collected this month	\$159,465.21		\$28,431.00		
Taxes collected year to date	\$21,106,845.88	96.26%	\$227,831.11	30.79%	
Penalty & Interest collected	\$55,682.91		\$61,081.30		
SIT Overage	\$5,832.70		\$0.00		
Appraisal Rendition Commission	\$957.51		\$9.05		
TOTAL COLLECTIONS YEAR TO DATE	\$21,167,403.98		\$288,903.36		
Rollback Taxes collected this month	\$1,386.86				
Rollback Taxes collected year to date	\$21,424.72				
Attorney Fees collected	\$4,287.99		\$50,656.58		

KAUFMAN COUNTY 2024-2025

April 2025

	CURRENT ROLL			DELINQUENT ROLL	
	M&O	I&S	%	2023 AND OLDER	%
GENERAL FUND					
Adjusted Tax Levy Roll	\$70,788,683.08	\$13,424,757.39	100.00%	\$3,029,937.89	100.00%
Amount to be collected	\$2,864,052.21	\$543,155.77	4.05%	\$2,296,344.54	75.79%
Amount collected this month	\$543,988.27	\$103,192.70		\$236,174.57	
Taxes collected year to date	\$67,925,140.87	\$12,886,289.89	95.96%	\$736,163.35	24.30%
Penalty & Interest collected	\$176,398.20	\$33,452.77		\$185,733.86	
SIT Overage	\$6,672.20	\$0.00		\$0.00	
Appraisal Rendition Commission	\$2,389.64	\$0.00		\$100.27	
TOTAL COLLECTIONS YEAR TO DATE	\$68,105,821.63	\$12,919,742.66		\$921,796.94	
TOTAL M&O AND I&S COLLECTIONS YTD	\$81,025,564.29				
Rollback Taxes collected this month	\$36,405.92				
Rollback Taxes collected year to date	\$98,902.03				
Attorney Fees collected	\$16,734.69			\$164,017.85	

KAUFMAN COUNTY ROAD & BRIDGE 2024-2025

April 2025

	CURRENT ROLL			DELINQUENT ROLL	
	AMOUNT	2024 ONLY	%	2023 AND OLDER	%
Adjusted Tax Levy Roll	\$20,517,582.60		100.00%	\$649,769.81	100.00%
Amount to be collected	\$813,114.30		3.96%	\$481,693.53	74.13%
Amount collected this month	\$157,393.63			\$53,678.58	
Taxes collected year to date	\$19,704,468.30		96.04%	\$168,076.28	25.87%
Penalty & Interest collected	\$51,357.25			\$42,212.02	
SIT Overage	\$1,654.95			\$0.00	
Appraisal Rendition Commission	\$592.77			\$24.55	
TOTAL COLLECTIONS YEAR TO DATE	\$19,756,887.73			\$210,263.75	
Rollback Taxes collected this month	\$7,904.66				
Rollback Taxes collected year to date	\$21,419.77				
Attorney Fees collected	\$4,147.50			\$38,357.88	

STATE OF TEXAS

*

COUNTY OF KAUFMAN

*

*

AFFIDAVIT

RE: KAUFMAN COUNTY ROAD & BRIDGE

I, the undersigned authority, TERESSA FLOYD, TAX ASSESSOR of Kaufman County, Texas, who being duly sworn do certify and say that to the best of my knowledge and belief that the attached exhibit is a true and correct report of all monies collected by this office for the period.

April 1, 2026, to April 30, 2026, as required by Title 1, Subtitle B,

Chapter 6 of the Texas Property Tax Code.

Certified to on this the 6th May 2026.

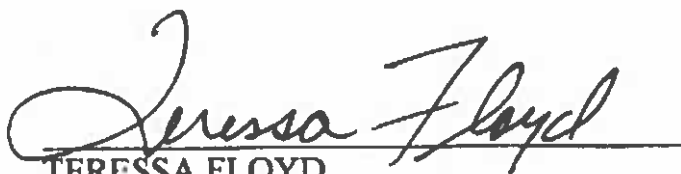
A handwritten signature in black ink that reads "Teressa Floyd". The signature is written in a cursive style with a large initial "T" and "F". A horizontal line is drawn across the signature.

TERESSA FLOYD
TAX ASSESSOR-COLLECTOR
KAUFMAN COUNTY

FISCAL START: 10/01/2025 FND: 09/30/2026 JURISDICTION: 0002 ROAD & BRIDGE

CURRENT YEAR	CURT TAXABLE VALUE	ADJUSTMENTS	ADJ TAX VALUE	TAX RATE	TAX LEVY	PAID ACCTS
25,165,420,665	112,771,830	28,218,192,495	00.080635	21,990,114.26	98,677	

YEAR	TAXES DUE	MONTH ADJ	ADJUSTMENT YTD	LEVY PAID	PAID YTD	BALANCE COLL %	YTD UNCOLL
2025	21,934,956.92	5,404.59	55,147.34	145,229.84	21,106,845.89	887,268.38	95.98
2024	347,862.30	429.55	11,082.50	13,662.42	127,610.00	206,159.89	38.23
2023	170,777.49	301.15	2,413.54	6,779.02	54,689.47	114,674.48	32.29
2022	68,494.26	260.85	3,873.80	2,161.00	21,810.08	50,557.98	30.44
2021	43,330.39	11.55	3,025.82	590.43	15,210.79	31,153.42	32.81
2020	25,855.05	1.12	48.36	184.42	3,393.28	22,510.13	13.10
2019	20,275.31	.00	0.00	72.52	1,679.58	18,595.93	8.28
2018	16,166.04	.00	5.47	96.07	1,829.98	15,341.53	9.53
2017	10,323.42	1.43	3.54	85.63	763.57	9,563.39	7.39
2016	8,421.11	1.32	3.25	24.73	597.69	7,826.47	7.10
2015	6,939.27	1.24	1,130.92	20.14	282.38	5,525.97	4.86
2014	4,331.52	.00	17.75	17.75	208.73	3,989.93	4.97
2013	3,988.18	.00	476.92	16.22	135.52	3,375.74	3.85
2012	2,734.21	.00	204.13	0.72	132.42	2,397.66	5.23
2011	2,877.59	.00	238.48	1.03	186.94	2,452.12	7.09
2010	7,381.96	.00	128.54	0.00	110.54	2,142.87	4.91
2009	3,218.46	.00	192.27	0.00	95.60	2,930.59	3.16
2008	3,495.80	.00	151.98	0.00	25.28	3,318.54	7.76
2007	3,177.85	.00	105.37	0.27	26.59	3,045.89	.87
2006	3,163.61	.00	50.77	0.00	13.76	3,099.08	.44
2005	2,237.24	.00	393.64	0.00	12.75	1,830.85	.69
2004	1,410.67	.00	3.00	0.00	13.48	1,397.19	.96
***	22,683,452.77	6,412.80	46,403.63	166,852.23	21,334,674.37	1,395,188.03	1,672.66
CURR	2,934,960.92	5,404.59	55,147.34	145,229.84	21,106,845.89	887,268.38	95.98
DELO	748,491.85	1,008.21	8,743.71	21,652.39	227,828.49	511,919.65	1,672.66

05/06/2026 13:18:53
 70298-D
 RECEIPT DATE: ALL
 LOCATION: ALL

TAX COLLECTION SYSTEM
 DEPOSIT DISTRIBUTION
 FROM: 04/01/2026 TO: 04/30/2026
 JURISDICTION: 0002 ROAD & BRIDGE

PAGE: 3
 INCLUDES AS ROLLBACK

YEAR	FUND	TAX RATE	LEVY PAID	DISCOUNT GIVEN	PENALTY INTEREST	TIF AMOUNT	DISBURSE TOTAL	ATTORNEY FEES	OTHER FEES	REFUND AMOUNT	PAYMENT AMOUNT
2025	M & O	.080615	145,223.84	.00	14,248.60	.00	159,472.44	1,824.38	.00	.00	161,302.82
	I & S	.000000	.00	.00	.00	.00	.00	.00	.00	.00	.00
	TOTAL	.080615	145,223.84	.00	14,248.60	.00	159,472.44	1,824.38	.00	.00	161,302.82
2024	M & O	.082500	12,562.42	.00	3,377.34	.00	17,039.76	3,069.95	.00	.00	20,109.71
	I & S	.000000	.00	.00	.00	.00	.00	.00	.00	.00	.00
	TOTAL	.082500	12,562.42	.00	3,377.34	.00	17,039.76	3,069.95	.00	.00	20,109.71
2023	M & O	.082500	4,779.92	.00	1,831.00	.00	6,580.02	1,493.40	.00	.00	8,073.42
	I & S	.000000	.00	.00	.00	.00	.00	.00	.00	.00	.00
	TOTAL	.082500	4,779.92	.00	1,831.00	.00	6,580.02	1,493.40	.00	.00	8,073.42
2022	M & O	.070412	2,101.00	.00	927.92	.00	2,928.92	635.82	.00	.00	3,564.74
	I & S	.000000	.00	.00	.00	.00	.00	.00	.00	.00	.00
	TOTAL	.070412	2,101.00	.00	927.92	.00	2,928.92	635.82	.00	.00	3,564.74
2021	M & O	.081526	590.43	.00	269.27	.00	859.70	152.76	.00	.00	1,012.26
	I & S	.000000	.00	.00	.00	.00	.00	.00	.00	.00	.00
	TOTAL	.081526	590.43	.00	269.27	.00	859.70	152.76	.00	.00	1,012.26
2020	M & O	.088635	184.42	.00	138.92	.00	323.34	64.91	.00	.00	388.25
	I & S	.000000	.00	.00	.00	.00	.00	.00	.00	.00	.00
	TOTAL	.088635	184.42	.00	138.92	.00	323.34	64.91	.00	.00	388.25
2019	M & O	.097940	72.52	.00	63.08	.00	135.60	27.11	.00	.00	162.71
	I & S	.000000	.00	.00	.00	.00	.00	.00	.00	.00	.00
	TOTAL	.097940	72.52	.00	63.08	.00	135.60	27.11	.00	.00	162.71
2018	M & O	.110000	96.07	.00	93.36	.00	189.43	37.64	.00	.00	227.07
	I & S	.000000	.00	.00	.00	.00	.00	.00	.00	.00	.00
	TOTAL	.110000	96.07	.00	93.36	.00	189.43	37.64	.00	.00	227.07
2017	M & O	.100000	85.63	.00	94.64	.00	180.27	36.04	.00	.00	216.31
	I & S	.000000	.00	.00	.00	.00	.00	.00	.00	.00	.00
	TOTAL	.100000	85.63	.00	94.64	.00	180.27	36.04	.00	.00	216.31
2016	M & O	.092000	24.73	.00	30.42	.00	55.15	11.03	.00	.00	66.18
	I & S	.000000	.00	.00	.00	.00	.00	.00	.00	.00	.00
	TOTAL	.092000	24.73	.00	30.42	.00	55.15	11.03	.00	.00	66.18
2015	M & O	.086700	20.14	.00	27.20	.00	47.34	9.47	.00	.00	56.81
	I & S	.000000	.00	.00	.00	.00	.00	.00	.00	.00	.00
	TOTAL	.086700	20.14	.00	27.20	.00	47.34	9.47	.00	.00	56.81
2014	M & O	.074000	17.75	.00	26.10	.00	43.85	8.77	.00	.00	52.62
	I & S	.000000	.00	.00	.00	.00	.00	.00	.00	.00	.00
	TOTAL	.074000	17.75	.00	26.10	.00	43.85	8.77	.00	.00	52.62

05/06/2026 12:18:53 -143284
 TC295-D SELECTION: DEPOSIT
 RECEIPT DATE: ALL
 LOCATION: ALL

TAX COLLECTION SYSTEM
 DEPOSIT DISTRIBUTION
 FROM: 04/01/2026 thru 04/30/2026
 JURISDICTION: 0002 ROAD & BRIDGE

PAGE: 4
 INCLUDES AG ROLLBACK

YEAR	FUND	TAX RATE	IFVY PAID	DISCOUNT GIVEN	PENALTY INTEREST	EIF AMOUNT	DISBURSE TOTAL	ATTORNEY	OTHER FEES	REBUND AMOUNT	PAYMENT AMOUNT
2013	M & O	.074000	16.22	.00	25.79	.00	42.01	8.60	.00	.00	50.41
	I & S	.000000	.00	.00	.00	.00	.00	.00	.00	.00	.00
	TOTAL	.074000	16.22	.00	25.79	.00	42.01	8.60	.00	.00	50.41
2012	M & O	.054500	.74	.00	1.27	.00	2.01	.60	.00	.00	2.41
	I & S	.000000	.00	.00	.00	.00	.00	.00	.00	.00	.00
	TOTAL	.054500	.74	.00	1.27	.00	2.01	.60	.00	.00	2.41
2011	M & O	.057400	1.03	.00	1.08	.00	2.91	.52	.00	.00	3.49
	I & S	.000000	.00	.00	.00	.00	.00	.00	.00	.00	.00
	TOTAL	.057400	1.03	.00	1.08	.00	2.91	.52	.00	.00	3.49
2007	M & O	.080000	.27	.00	.49	.00	.76	.13	.00	.00	.89
	I & S	.000000	.00	.00	.00	.00	.00	.00	.00	.00	.00
	TOTAL	.080000	.27	.00	.49	.00	.76	.13	.00	.00	.89
ALL	M & O		166,982.23	.00	21,077.08	.00	197,909.31	7,360.79	.00	.00	195,253.10
ALL	I & S		.00	.00	.00	.00	.00	.00	.00	.00	.00
ALL	TOTAL		166,982.23	.00	21,077.08	.00	197,909.31	7,360.79	.00	.00	195,253.10
DIQ	M & O		21,652.39	.00	6,772.48	.00	28,430.87	5,556.41	.00	.00	33,987.28
DIQ	I & S		.00	.00	.00	.00	.00	.00	.00	.00	.00
DIQ	TOTAL		21,652.39	.00	6,772.48	.00	28,430.87	5,556.41	.00	.00	33,987.28
CURR	M & O		145,223.84	.00	14,248.60	.00	159,478.44	1,824.38	.00	.00	161,302.92
CURR	I & S		.00	.00	.00	.00	.00	.00	.00	.00	.00
CURR	TOTAL		145,223.84	.00	14,248.60	.00	159,478.44	1,824.38	.00	.00	161,302.92

05/06/2026 13:11:19
 TC798-P SELECTION: DEPOSIT

TAX COLLECTION SYSTEM
 DEPOSIT DISTRIBUTION
 PENALTY & INTEREST ALLOCATION SCHEDULE
 FROM: 04/01/2026 THRU 04/30/2026
 JURISDICTION: 0002 ROAD & BRIDGE

PAGE: 7

YEAR	GENERAL OPERATING PENALTY AMT	INTEREST AMT	INTEREST AND SINKING PENALTY AMT	SPECIAL BOND FUND 1 PENALTY AMT	INTEREST AMT	SPECIAL BOND FUND 2 PENALTY AMT	INTEREST AMT	TOTAL PEN / INT
2025	10,464.08	1,784.52						14,268.60
2024	1,472.40	1,904.94						3,377.34
2023	604.78	1,191.22						1,801.00
2022	249.58	587.34						827.92
2021	58.65	210.41						269.07
2020	22.21	116.71						138.92
2019	9.71	54.37						63.08
2018	11.53	61.82						73.36
2017	10.27	64.37						74.64
2016	7.97	71.45						79.42
2015	2.42	24.78						27.20
2014	2.13	23.97						26.10
2013	1.95	23.84						25.79
2012	0.09	1.18						1.27
2011	0.12	1.76						1.88
2007	0.03	0.45						0.49
****	12,903.93	9,119.15		0.00	0.00	0.00	0.00	21,022.08
DY	2,442.85	4,324.63		0.00	0.00	0.00	0.00	6,778.48

Multiple batches found for this date range.
 For Deposit Dates 04/01/2026 thru 04/30/2026
 File Type: PROPERTY TAX

TCS297F Detail

Report run on: May 6, 2026 1:13 PM

Ver. 1.3

Tax Unit	Attorney	TTF Levy	TTF Penalty/ Interest	Fees/ Refunds	Levy	Penalty/ Interest	Current Year Total	Prior Year Total	Disburse Total
2	I & S	\$0.00	\$0.00	\$0.00	\$0.00	\$0.00	\$0.00	\$0.00	\$0.00
	M & O	\$1,824.38	\$0.00	\$0.00	\$145,229.84	\$14,248.60	\$159,478.44	\$0.00	\$159,478.44
2025	I & S	\$0.00	\$0.00	\$0.00	\$145,229.84	\$14,248.60	\$159,478.44	\$0.00	\$159,478.44
	M & O	\$3,069.95	\$0.00	\$0.00	\$13,662.42	\$3,377.34	\$0.00	\$17,039.76	\$17,039.76
2024	I & S	\$3,069.95	\$0.00	\$0.00	\$13,662.42	\$3,377.34	\$0.00	\$17,039.76	\$17,039.76
	M & O	\$0.00	\$0.00	\$0.00	\$0.00	\$0.00	\$0.00	\$0.00	\$0.00
2023	I & S	\$1,493.40	\$0.00	\$0.00	\$4,779.02	\$1,801.00	\$0.00	\$6,580.02	\$6,580.02
	M & O	\$635.82	\$0.00	\$0.00	\$2,101.00	\$827.92	\$0.00	\$2,928.92	\$2,928.92
2022	I & S	\$635.82	\$0.00	\$0.00	\$2,101.00	\$827.92	\$0.00	\$2,928.92	\$2,928.92
	M & O	\$152.76	\$0.00	\$0.00	\$0.00	\$0.00	\$0.00	\$0.00	\$0.00
2021	I & S	\$152.76	\$0.00	\$0.00	\$590.43	\$269.07	\$0.00	\$859.50	\$859.50
	M & O	\$64.91	\$0.00	\$0.00	\$184.42	\$138.92	\$0.00	\$323.34	\$323.34
2020	I & S	\$64.91	\$0.00	\$0.00	\$184.42	\$138.92	\$0.00	\$323.34	\$323.34
	M & O	\$0.00	\$0.00	\$0.00	\$0.00	\$0.00	\$0.00	\$0.00	\$0.00
2019	I & S	\$27.11	\$0.00	\$0.00	\$72.52	\$63.08	\$0.00	\$135.60	\$135.60
	M & O	\$37.64	\$0.00	\$0.00	\$96.07	\$93.36	\$0.00	\$189.43	\$189.43
2018	I & S	\$37.64	\$0.00	\$0.00	\$96.07	\$93.36	\$0.00	\$189.43	\$189.43
	M & O	\$0.00	\$0.00	\$0.00	\$0.00	\$0.00	\$0.00	\$0.00	\$0.00
2017	I & S	\$0.00	\$0.00	\$0.00	\$85.63	\$94.64	\$0.00	\$180.27	\$180.27
	M & O	\$11.03	\$0.00	\$0.00	\$24.73	\$30.42	\$0.00	\$55.15	\$55.15
2016	I & S	\$11.03	\$0.00	\$0.00	\$24.73	\$30.42	\$0.00	\$55.15	\$55.15
	M & O	\$0.00	\$0.00	\$0.00	\$0.00	\$0.00	\$0.00	\$0.00	\$0.00
2015	I & S	\$0.00	\$0.00	\$0.00	\$0.00	\$0.00	\$0.00	\$0.00	\$0.00
	M & O	\$9.47	\$0.00	\$0.00	\$20.14	\$37.20	\$0.00	\$47.34	\$47.34
2014	I & S	\$9.47	\$0.00	\$0.00	\$20.14	\$37.20	\$0.00	\$47.34	\$47.34
	M & O	\$0.00	\$0.00	\$0.00	\$0.00	\$0.00	\$0.00	\$0.00	\$0.00
2013	I & S	\$0.00	\$0.00	\$0.00	\$17.75	\$26.10	\$0.00	\$43.85	\$43.85
	M & O	\$8.77	\$0.00	\$0.00	\$17.75	\$26.10	\$0.00	\$43.85	\$43.85

Multiple batches found for this date range.
 For Deposit Dates 04/01/2026 thru 04/30/2026
 File Type: PROPERTY TAX

TCS297F Detail

Report run on: May 6, 2026 1:13 PM
 Ver. 1.3

Tax Unit	Attorney	TIF Levy	TIF Penalty/ Interest	Fees/ Refunds	Levy	Penalty/ Interest	Current Year Total	Prior Year Total	Disburse Total
2									
I & S	\$0.00	\$0.00	\$0.00	\$0.00	\$0.00	\$0.00	\$0.00	\$0.00	\$0.00
M & O	\$8.40	\$0.00	\$0.00	\$0.00	\$16.22	\$25.79	\$0.00	\$42.01	\$42.01
2013	\$8.40	\$0.00	\$0.00	\$0.00	\$16.22	\$25.79	\$0.00	\$42.01	\$42.01
I & S	\$0.00	\$0.00	\$0.00	\$0.00	\$0.00	\$0.00	\$0.00	\$0.00	\$0.00
M & O	\$0.40	\$0.00	\$0.00	\$0.00	\$0.74	\$1.27	\$0.00	\$2.01	\$2.01
2012	\$0.40	\$0.00	\$0.00	\$0.00	\$0.74	\$1.27	\$0.00	\$2.01	\$2.01
I & S	\$0.00	\$0.00	\$0.00	\$0.00	\$0.00	\$0.00	\$0.00	\$0.00	\$0.00
M & O	\$0.58	\$0.00	\$0.00	\$0.00	\$1.03	\$1.68	\$0.00	\$2.91	\$2.91
2011	\$0.58	\$0.00	\$0.00	\$0.00	\$1.03	\$1.68	\$0.00	\$2.91	\$2.91
I & S	\$0.00	\$0.00	\$0.00	\$0.00	\$0.00	\$0.00	\$0.00	\$0.00	\$0.00
M & O	\$0.13	\$0.00	\$0.00	\$0.00	\$0.27	\$0.49	\$0.00	\$0.76	\$0.76
2007	\$0.13	\$0.00	\$0.00	\$0.00	\$0.27	\$0.49	\$0.00	\$0.76	\$0.76
TCS298F	\$7,300.79	\$0.00	\$0.00	\$0.00	\$166,882.23	\$21,027.08	\$159,478.44	\$28,430.87	\$187,909.31
I & S	\$0.00	\$0.00	\$0.00	\$0.00	\$0.00	\$0.00	\$0.00	\$0.00	\$0.00
M & O	\$0.00	\$0.00	\$0.00	\$0.00	\$0.00	(\$13.23)	(\$13.23)	\$0.00	(\$13.23)
2025	\$0.00	\$0.00	\$0.00	\$0.00	\$0.00	(\$13.23)	(\$13.23)	\$0.00	(\$13.23)
I & S	\$0.00	\$0.00	\$0.00	\$0.00	\$0.00	\$0.00	\$0.00	\$0.00	\$0.00
M & O	\$0.00	\$0.00	\$0.00	\$0.00	\$0.00	(\$0.23)	\$0.00	(\$0.23)	(\$0.23)
2024	\$0.00	\$0.00	\$0.00	\$0.00	\$0.00	(\$0.23)	\$0.00	(\$0.23)	(\$0.23)
I & S	\$0.00	\$0.00	\$0.00	\$0.00	\$0.00	\$0.00	\$0.00	\$0.00	\$0.00
M & O	\$0.00	\$0.00	\$0.00	\$0.00	\$0.00	\$0.47	\$0.00	\$0.47	\$0.47
2023	\$0.00	\$0.00	\$0.00	\$0.00	\$0.00	\$0.47	\$0.00	\$0.47	\$0.47
I & S	\$0.00	\$0.00	\$0.00	\$0.00	\$0.00	\$0.00	\$0.00	\$0.00	\$0.00
M & O	\$0.00	\$0.00	\$0.00	\$0.00	\$0.00	(\$0.11)	\$0.00	(\$0.11)	(\$0.11)
2022	\$0.00	\$0.00	\$0.00	\$0.00	\$0.00	(\$0.11)	\$0.00	(\$0.11)	(\$0.11)
TCS298X	\$0.00	\$0.00	\$0.00	\$0.00	\$0.00	(\$13.10)	(\$13.23)	\$0.13	(\$13.10)
Current Total:	\$1,824.38	\$0.00	\$0.00	\$0.00	\$149,229.84	\$14,234.37	\$159,465.21	\$0.00	\$159,465.21
Prior Year Total:	\$5,556.41	\$0.00	\$0.00	\$0.00	\$21,652.19	\$6,778.61	\$0.00	\$28,431.00	\$28,431.00
Total:	\$7,380.79	\$0.00	\$0.00	\$0.00	\$166,882.23	\$21,013.98	\$159,465.21	\$28,431.00	\$187,896.21

Jurisdiction Remittances Processed By Disbursing Tax Unit Property Tax File
 For Remitted Deposit Dates 04/01/2026 thru 04/30/2026 as of 05/06/2026

Report run on: May 6, 2026 1:15 PM

5143273

Tax Unit	M & O Total	I & S Total	TIF Levy	TIF Interest	Fee Total	Total
2 ROAD & BRIDGE						
ACH 33533 Print Date: 04/15/2026						
Current	73,042.79	0.00	0.00	0.00	0.00	73,042.79
Delq	14,909.51	0.00	0.00	0.00	0.00	14,909.51
Subtotal:	\$87,952.30	\$0.00	\$0.00	\$0.00	\$0.00	\$87,952.30
2 ROAD & BRIDGE						
ACH 33590 Print Date: 04/22/2026						
Current	25,049.90	0.00	0.00	0.00	0.00	25,049.90
Delq	3,839.47	0.00	0.00	0.00	0.00	3,839.47
Subtotal:	\$28,889.37	\$0.00	\$0.00	\$0.00	\$0.00	\$28,889.37
2 ROAD & BRIDGE						
ACH 33640 Print Date: 05/06/2026						
Current	61,372.52	0.00	0.00	0.00	0.00	61,372.52
Delq	9,682.02	0.00	0.00	0.00	0.00	9,682.02
Subtotal:	\$71,054.54	\$0.00	\$0.00	\$0.00	\$0.00	\$71,054.54
Tax Unit Subtotal:	\$187,896.21	\$0.00	\$0.00	\$0.00	\$0.00	\$187,896.21

KAUFMAN COUNTY

**Rendition Commission Distribution Detail
from 04/01/2026 to 04/30/2026**

Date: 05/06/2026 13:17:15

2

Tax Unit: 2 ROAD & BRIDGE

Account No.	Year	Deposit	Levy Collected	Rendition Penalty	P & I Collected	Rendition P & I	Appraisal Commission	Disbursement Amount
188781	2025	042826CPCC	15.93	1.45	1.75	0.00	0.07	17.61
189707	2025	04222026AR	4.61	0.42	0.51	0.00	0.02	5.10
193862129	2025	042826CPCC	5.76	0.52	0.63	0.00	0.03	6.36
198985129	2025	04212026SN	33.26	6.05	3.66	0.00	0.30	36.62
204130	2025	042126CPECK	7.10	0.65	0.78	0.00	0.03	7.85
219408129	2025	042726CPCC	5.76	0.52	0.63	0.00	0.03	6.36
220316129	2025	042926CPCC	5.50	0.50	0.61	0.00	0.03	6.08
235491129	2025	040126CPCC	55.66	5.06	5.01	0.00	0.25	60.42
67982	2025	040626CPCC2	17.74	1.61	1.95	0.00	0.08	19.61
68832	2025	04012026AR	26.41	2.40	2.91	0.00	0.12	29.20
78213	2025	04082026TA	16.97	1.57	1.87	0.00	0.08	18.76
234207129	2025	04102026CA	18.93	8.87	2.09	0.00	0.44	20.58
185465	2025	040126CPCC	5.76	0.52	0.52	0.00	0.03	6.25
186537	2025	04082026TA	8.87	0.81	0.80	0.00	0.04	9.63
186660	2025	040126CPECK	44.35	4.03	3.99	0.00	0.20	48.14
187596	2025	040626CPECK	108.24	58.86	11.91	0.00	2.94	117.21
197653129	2025	040926CPECK	207.56	18.87	22.83	0.00	0.94	229.45
213237129	2025	040126CPCC	11.53	1.05	1.04	0.00	0.05	12.52
204233	2025	04072026TA	5.19	0.47	0.47	0.00	0.02	5.64
225117129	2025	040626CPCC	8.87	0.81	0.98	0.00	0.04	9.81
227098129	2025	04022026SN	706.43	64.22	63.58	0.00	3.21	766.60
227099129	2025	04022026SN	106.44	9.66	9.58	0.00	0.48	115.54
225008129	2025	042826CPCC	266.10	24.19	29.27	0.00	1.21	294.16

KAUFMAN COUNTY

**Rendition Commission Distribution Detail
from 04/01/2026 to 04/30/2026**

Date: 05/06/2026 13:17:15

2

Tax Unit: 2 ROAD & BRIDGE

Account No.	Year	Deposit	Levy Collected	Rendition Penalty	P & I Collected	Rendition P & I	Appraisal Commission	Disbursement Amount
225025128	2025	04212026TA	21.65	3.97	2.38	0.00	0.20	23.83
227163129	2025	042726CPCC	16.85	1.53	1.85	0.00	0.08	18.62
233071129	2025	042826CPECK	-4.43	-0.40	-0.49	0.00	-0.02	-4.90
233071129	2025	042826CPCC	4.43	0.40	0.49	0.00	0.02	4.90
233077129	2025	042426CPCC	8.87	0.81	0.98	0.00	0.04	9.81
240370129	2025	042826CPCC	7.10	0.65	0.78	0.00	0.03	7.86
240386128	2025	042726CPCC	8.87	0.81	0.98	0.00	0.04	9.81
240426128	2025	04242026KGB	70.86	6.45	7.81	0.00	0.32	78.45
240426129	2025	04242026KGB	-70.96	-6.45	-7.81	0.00	-0.32	-78.45
240426129	2025	04242026SN	70.96	6.45	7.81	0.00	0.32	78.45
240431129	2025	042726CPCC	8.74	2.02	0.96	0.00	0.10	9.60
240431129	2025	042826REVSN	-8.74	-2.02	-0.96	0.00	-0.10	-9.60
240442129	2025	04212026TA	8.87	0.81	0.98	0.00	0.04	9.81
240448129	2025	04282026TA	66.53	6.05	7.32	0.00	0.30	73.55
241599129	2025	042726CPCC1	35.48	3.23	3.90	0.00	0.16	38.22
3195328	2025	042726CPCC2	93.40	8.49	10.27	0.00	0.42	103.25
3195840	2025	04302026MB	5.76	0.52	0.63	0.00	0.03	6.36
241131129	2025	040126CPCC	8.87	0.81	0.80	0.00	0.04	9.63
184551	2025	04142026TA	71.56	6.51	7.87	0.00	0.33	79.10
186423	2025	041426CPECK	2.22	0.20	0.24	0.00	0.01	2.45
204427	2025	041626CPCC	11.53	1.05	1.27	0.00	0.05	12.75
225413129	2025	041326CPCC	17.29	1.57	1.90	0.00	0.08	19.11
240101128	2025	041426CPCC	4.43	0.40	0.49	0.00	0.02	4.90

KAUFMAN COUNTY

**Rendition Commission Distribution Detail
from 04/01/2026 to 04/30/2026**

Date: 05/06/2026 13:17:15

Tax Unit Page: 3 of 3

2

Tax Unit: 2 ROAD & BRIDGE

Account No.	Year	Deposit	Levy Collected	Rendition Penalty	P & I Collected	Rendition P & I	Appraisal Commission	Disbursement Amount
73463	2025	04142026TA	42.17	7.73	4.63	0.00	0.39	46.41
184430	2025	042926CPECK	2.68	0.24	0.29	0.00	0.01	2.98
Total for 2025			2,198.06	264.96	222.74	0.00	13.23	2,407.57
Account No.	Year	Deposit	Levy Collected	Rendition Penalty	P & I Collected	Rendition P & I	Appraisal Commission	Disbursement Amount
176446	2024	040126CPCC	21.24	1.93	5.32	0.00	0.10	28.66
3194433	2024	040826CPCC	12.85	2.68	3.46	0.00	0.13	16.18
Total for 2024			34.08	4.61	8.98	0.00	0.23	42.84
Account No.	Year	Deposit	Levy Collected	Rendition Penalty	P & I Collected	Rendition P & I	Appraisal Commission	Disbursement Amount
195026129	2023	04242026SN	7.12	7.12	2.77	0.00	0.36	9.53
195026129	2023	04242026KGB	-7.12	-16.50	-2.77	0.00	-0.83	-9.06
Total for 2023			0.00	-8.38	0.00	0.00	-0.47	0.47
Account No.	Year	Deposit	Levy Collected	Rendition Penalty	P & I Collected	Rendition P & I	Appraisal Commission	Disbursement Amount
216326129	2022	042726CPCC1	25.17	2.29	12.84	0.00	0.11	37.90
Total for 2022			25.17	2.29	12.84	0.00	0.11	37.90
Total for Tax Unit 2 ROAD & BRIDGE			2,257.32	262.48	244.56	0.00	13.10	2,488.78



Kaufman County
Tax Assessor/Collector
 Teresa Floyd
 100 N. Washington
 PO Box 339
 Kaufman, Texas 75142

Registration and Title System
 Month - to - Date Fees Report

TITLES	April		Current year		2026		2025	
	Quantity	Monies Collected	Quantity	Monies Collected	Quantity	Monies Collected	Quantity	Monies Collected
Title Application Fee	2836	\$36,868.00	2558	\$33,254.00				
Other Fees Collected	52	\$3,380.00	76	\$4,940.00				
Total		\$40,248.00		\$38,194.00				
REGISTRATION								
Windshield Sticker	11537	\$637,870.35	11256	\$619,604.31				
Plate Sticker	2139	\$97,399.08	2073	\$89,950.58				
County Road Bridge Add-On Fee	13413	\$134,130.00	13072	\$130,720.00				
Other Fees Collected	69523	\$366,710.81	72025	\$344,628.47				
Total		\$1,236,110.24		\$1,184,903.36				
SALES TAX								
Sales Tax Fee	3832	\$2,185,067.57	2945	\$2,031,998.19				
Texas Mobility Fund Fee (TERP)	2836	\$55,800.00	2558	\$50,280.00				
Other Fees Collected	297	\$22,370.24	47	\$10,544.02				
Total		\$2,263,237.81		\$2,092,822.21				
GRAND TOTAL		\$3,539,596.05		\$3,315,919.57				

KAUFMAN COUNTY COMMISSIONERS' COURT AGENDA REQUEST FORM

Note: This form is required for agenda requests, with the exception of supporting materials or attachments. Forms should be returned to the County Judge's Office by email to Ashley.kirby@kaufmancounty.net and Kasey.hovis@kaufmancounty.net at the Justice Center located at 1902 US Hwy. 175, Kaufman, Texas, 75142 for inclusion on the court's agenda. Items will not be included if submitted after the deadline which is **Tuesday at 12:00 P.M (Noon)** preceding the court meeting. Items will also be omitted if no supporting documents are included with your request. Regular court meetings are held each Tuesday of the month.

COURT DATE REQUESTED: 6/9/26	SUBMITTED BY: Brandi Van Huss/ Janas Byrnes DEPARTMENT: Children's Shelter	PERSON PRESENTING: N/A
--	---	--------------------------------------

ITEM REQUESTED IS FOR:

- Consent Agenda
- Action/Consideration
- Discussion/Report
- Executive Session
- Public Workshop

ITEM: (PLEASE STATE EXACTLY AS YOU WANT TO APPEAR ON THE AGENDA)

Approve changing the part-time Administrative Assistant to full-time effective 6/1/26 and establishing a new Case Manager position for the remainder of FY2026.

KAUFMAN COUNTY COMMISSIONERS' COURT AGENDA REQUEST FORM

Note: This form is required for agenda requests, with the exception of supporting materials or attachments. Forms should be returned to the County Judge's Office by email to Ashley.kirby@kaufmancounty.net and Kasey.hovis@kaufmancounty.net at the Justice Center located at 1902 US Hwy. 175, Kaufman, Texas, 75142 for inclusion on the court's agenda. Items will not be included if submitted after the deadline which is **Tuesday at 12:00 P.M (Noon)** preceding the court meeting. Items will also be omitted if no supporting documents are included with your request. Regular court meetings are held each Tuesday of the month.

COURT DATE REQUESTED: 6/9/26	SUBMITTED BY: Pam Corder DEPARTMENT: Project Manager	PERSON PRESENTING: Pam Corder
--	---	---

ITEM REQUESTED IS FOR:

- Consent Agenda
- Action/Consideration
- Discussion/Report
- Executive Session
- Public Workshop

ITEM: (PLEASE STATE EXACTLY AS YOU WANT TO APPEAR ON THE AGENDA)

Discuss and approve donation to the Kaufman County Historical Commission of \$1,000.00 from Brinson Chevrolet.

KAUFMAN COUNTY COMMISSIONERS' COURT AGENDA REQUEST FORM

Note: This form is required for agenda requests, with the exception of supporting materials or attachments. Forms should be returned to the County Judge's Office by email to Ashley.kirby@kaufmancounty.net and Kasey.hovis@kaufmancounty.net at the Justice Center located at 1902 US Hwy. 175, Kaufman, Texas, 75142 for inclusion on the court's agenda. Items will not be included if submitted after the deadline which is **Tuesday at 12:00 P.M (Noon)** preceding the court meeting. Items will also be omitted if no supporting documents are included with your request. Regular court meetings are held each Tuesday of the month.

COURT DATE REQUESTED: 6/9/26	SUBMITTED BY: Kaitlyn Joyner DEPARTMENT: Human Resources	PERSON PRESENTING: Kaitlyn Joyner
--	---	---

ITEM REQUESTED IS FOR: <input type="radio"/> Consent Agenda <input checked="" type="radio"/> Action/Consideration <input type="radio"/> Discussion/Report <input type="radio"/> Executive Session <input type="radio"/> Public Workshop

ITEM: (PLEASE STATE EXACTLY AS YOU WANT TO APPEAR ON THE AGENDA) Requesting approval on the service agreement/contract with UT Southwestern for their Mobile Mammogram trailer.

NEW	X
REVISED	
CANCELLED	

MOBILE MAMMOGRAPHY SERVICE AGREEMENT

Client Contact: Kaitlyn Joyner	DATE: 06/01/2026
Company Name: Kaufman County	UTSW Contact: Sydney McCauley / Mobile Mammography Imaging Mngr.
Address: 100 N Washington St. Kaufman, TX 75142	P: 214.645.2518
Phone: 469-376-4541	F: 214.645.2598
Email: kaitlyn.joyner@kaufmancounty.net	sydney.mccauley@utsouthwestern.edu

Reservation Date(s): 09/16/2026	Audience: Employees
Screening Hours: 8 AM - 3 PM*	
*Or until the last patient is screened	

Participation Requirements:

Minimum of 10 and a maximum of 24 participants are requested to be pre-registered for the event screening two (2) business days in advance or the event is subject to reduced screening hours and/or cancellation. It is the Client's responsibility to monitor the booking requirement of their event. As a courtesy, the Mobile Coordinator will monitor scheduled appointments, and notify Client if minimum numbers are not scheduled two (2) business days in advance of event date. Participants must call 214.645.2560 to schedule their individual appointments.

Publications:

Client will not make any press releases, public statements, advertisement or other promotional materials using the name or logo of UT Southwestern or the name of any UT Southwestern employee, or referring to this Agreement or the engagement of Client as an independent contractor of UT Southwestern, or the purchase of goods or services by UT Southwestern, without the prior written approval of UT Southwestern. Requests for prior written approval of any such releases, public statements, advertisements or other promotional materials must be submitted at least 10 days in advance of the planned publication date and should be directed to University's Executive Vice President for Institutional Advancement.

Participant Billing Information:

Prior to scheduling a screening event, Client is responsible for verifying their company's health insurance is in network with UT Southwestern. Participants will need to provide health insurance information when scheduling their appointment. Each Participant must present their photo ID and health insurance card at check-in on the day of their screening.

UT Southwestern Benefit Plans: Visit www.utsouthwestern.edu for all participation insurance plans.

Parking/Restroom Requirements:

Parking considerations for the Mobile Mammography Unit are essential to a successful Screening Event. The Client is responsible for providing an appropriate parking area for the unit: a 70' paved level parking surface, designated as 'reserved' for the Mobile Unit with access as early as 6:00AM on the Event date. For pedestrian safety, a security perimeter will be designated by the Mobile Unit driver. Additionally, staff will need access to restroom facilities on Event Day. The Client is responsible for adhering to these requirements or be subject to forfeiture of the Unit for service on the event date.

Cancellation Policy:

Client agrees to provide written notice (via certified mail, email or fax) of any intent to cancel their scheduled Event no less than two (2) business days prior to the agreed event. The Mobile Coordinator may cancel, postpone, or reschedule the event for the Client within two (2) business days advance notice of the contracted event date without penalty to the Client. Additionally, the mobile coordinator reserves the right to cancel an event due to low participation, inclement weather, or technical difficulties. Should an event be cancelled, the Client contact will be notified and an alternate date will be arranged. All scheduled Participants will be notified by the mobile unit's call center staff.

Additional Insured:

Client hereby [does does not] request to be listed as an additional insured on the UTSW commercial insurance policy.

_____ CLIENT SIGNATURE	_____ DATE	_____ NAME	_____ TITLE
_____ UT SOUTHWESTERN MEDICAL CENTER	_____ DATE	_____ NAME	_____ TITLE

PLEASE HAVE PARTICIPANTS CALL TO SCHEDULE THEIR INDIVIDUAL APPOINTMENTS: (214) 645.2560 OR TOLL FREE (866) 277.0710

KAUFMAN COUNTY COMMISSIONERS' COURT AGENDA REQUEST FORM

Note: This form is required for agenda requests, with the exception of supporting materials or attachments. Forms should be returned to the County Judge's Office by email to Ashley.kirby@kaufmancounty.net and Kasey.hovis@kaufmancounty.net at the Justice Center located at 1902 US Hwy. 175, Kaufman, Texas, 75142 for inclusion on the court's agenda. Items will not be included if submitted after the deadline which is **Tuesday at 12:00 P.M (Noon)** preceding the court meeting. Items will also be omitted if no supporting documents are included with your request. Regular court meetings are held each Tuesday of the month.

COURT DATE REQUESTED: 6/9/26	SUBMITTED BY: Shannon Roden DEPARTMENT: Development Services	PERSON PRESENTING: Shannon Roden with Development Services
--	---	---

ITEM REQUESTED IS FOR: <input type="radio"/> Consent Agenda <input checked="" type="radio"/> Action/Consideration <input type="radio"/> Discussion/Report <input type="radio"/> Executive Session <input type="radio"/> Public Workshop

ITEM: (PLEASE STATE EXACTLY AS YOU WANT TO APPEAR ON THE AGENDA) Discuss/Consider/Approve the replat of Lot 27 of Farm View Estates located on Crow Lane in Precinct 1.

STATE OF TEXAS
COUNTY OF KAUFMAN

AFFIDAVIT
INSTALLATION OF FIRE SERVICE FEATURES

Project Name: Farm View Estates Lot 27
Project Location: 1121 Crow Ln Terrell Tx 75161

The Kaufman County Fire Marshal's Office requires the installation of fire service features, including fire apparatus access roads and water supply for fire suppression, for all commercial establishments, public buildings, and multi-family residential dwellings consisting of four or more units. In addition, *if proposed lots do not front an existing road; then all new infrastructure must conform with adopted Fire Code.*

BEFORE THE UNDERSIGNED AUTHORITY PERSONALLY APPEARED THE AFFIANT HEREIN, WHO, BEING DULY SWORN, STATED UPON AFFIANT'S OATH THE FOLLOWING:

_____ This plat will require new infrastructure (See definition, in the Kaufman County Subdivision and Land Development Regulations) and/or is designed with the intent of constructing or substantially improving a commercial establishment, public building, or multi-family residential dwelling consisting of four or more units.

- OR -

X This plat **WILL NOT** require any new infrastructure and **IS NOT** designed with the intent of constructing or substantially improving a commercial establishment, public building, or multi-family residential dwelling consisting of four or more units.

WHEREFORE, the Affiant acknowledges that any changes to the design of the plat or its intended use will require a new submittal and/or replat.

Affiant Signature

SUBSCRIBED AND SWORN TO before me by said affiant on this 11th day of NOVEMBER, 2025
A.D., at _____

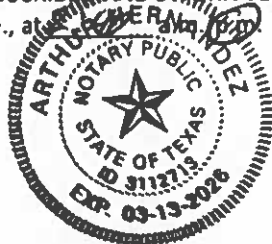

Notary Public in and for The State of Texas

03-13-2026
My commission expires on:

Office Use only:
Is Fire Flow Required: YES NO

Fire Marshal Reviewed: Christa Dickey Date of Review: 11/11/25

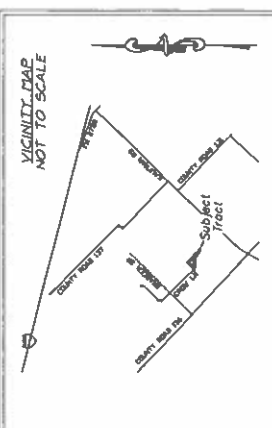

LEGEND

○ CONCRETE FOUNDATION
 ○ CABINET FRONT BY THIS PLAT
 ○ CABINET FRONT BY THIS PLAT
 ○ BUILDING LINE
 ○ 3/8" IRON ROD FOUND
 ○ 1/2" IRON ROD SET YELLOW
 ○ POINT FOR CORNER
 ○ "X" SET IN CONCRETE ASPHALT

STATE OF TEXAS
COUNTY OF KAUFMAN

WHEREAS, Eloy Medrano, on the Owner of a tract of land included in the B. Kimberling Survey, Abstract No. 529, Kaufman County, Texas, being all of that certain called 3.54 acre tract of land, described as Lot 27 of said Farm View Estates, according to the plat thereof, as recorded in Cabinet 2, Survey 529, Kaufman County, Texas, and the same being more particularly described as follows, to-wit: the Southeast corner of said Lot 27, which a 3/8" iron rod found at the West corner of said Lot 27, and d. the South corner of said Lot 27, which a 3/8" iron rod found at the Southwest corner of Lot 22 of said Farm View Estates bears North 46 degrees 17 minutes 55 seconds West, a distance of 652.60 feet, for reference;

THENCE North 43 degrees 42 minutes 05 seconds East, with the common line of said Lot 27 and said Lot 26, a distance of 440.20 feet to a point for corner in a 2" steel post found at the North corner of said Lot 27 and at the East corner of said Lot 26, and on a Southwest line of a called 45.471 acre tract of land conveyed to Eloy Medrano, et al, by Warranty Deed with Vendor's Lien, recorded in Cabinet 2, Survey 529, Kaufman County, Texas, which a 3/8" iron rod found at the North corner of Lot 25 of said Farm View Estates bears North 46 degrees 17 minutes 55 seconds West, a distance of 559.43 feet, for reference;

THENCE South 46 degrees 17 minutes 55 seconds East, with the common line of said Lot 27 and said Lot 26, a distance of 440.20 feet to a point for corner in a 2" steel post found at the Southwest corner of said Lot 27, at the Northwest corner of Lot 26 of said Farm View Estates, and at a North corner of a called 7.578 acre tract of land conveyed to Steven Moody et al, by Warranty Deed with Vendor's Lien, recorded in Cabinet 2, Survey 529, Kaufman County, Texas, which a 3/8" iron rod found at the North corner of Lot 25 of said Farm View Estates bears North 43 degrees 42 minutes 05 seconds East, a distance of 479.03 feet, and a 3/8" iron rod found at the East corner of Lot 37 of said Farm View Estates bears South 43 degrees 37 minutes 22 seconds West, a distance of 1374.60 feet, for reference;

THENCE South 06 degrees 52 minutes 55 seconds West, with the common line of said Lot 27 and said Lot 26, a distance of 596.12 feet to a point for corner in a 2" steel post found at a Southwest corner of said Lot 27, at the Northwest corner of Lot 26 of said Farm View Estates, and at a North corner of a called 7.578 acre tract of land conveyed to Steven Moody et al, by Warranty Deed with Vendor's Lien, recorded in Cabinet 2, Survey 529, Kaufman County, Texas, which a 3/8" iron rod found at the Southwest corner of said Lot 26 bears South 21 degrees 16 minutes 47 seconds West, a distance of 457.74 feet, and a 3/8" iron rod found at the Northwest corner of Lot 24 of said Farm View Estates bears South 02 degrees 54 minutes 17 seconds West, a distance of 457.74 feet, and a 3/8" iron rod found at the beginning of a curve to the left, with a radius of 90.00 feet, a delta angle of 115 degrees 56 minutes 34 seconds, the chord of which bears North 59 degrees 39 minutes 39 seconds West, for a chord distance of 152.60 feet;

THENCE along the arc of said curve, with the West line of said Lot 27 and with the Right of Way of said Crow Lane, an arc length of 102.12 feet to a point at a South corner of said Lot 27, from which a 3/8" iron rod found bears South 76 degrees 55 minutes 05 seconds East, a distance of 0.55 feet, for reference;

THENCE North 46 degrees 17 minutes 55 seconds West, with the Southwest line of said Lot 27 and said Lot 26, a distance of 215.56 feet to the POINT OF BEGINNING and CONTAINING 3.54 acres of land.

OWNERS/APPLICANT
ELOY MEDRANO
 1181 CROW LN
 TERRELL, TX 75761
 Phone: (214) 878-9810

PROJECT NAME:
FARM VIEW ESTATES LOT 27

ADDRESS:
 1121 CROW LN
 TERRELL, TX 75761
 ACREAGE: 3.54 ACRES
 BY-LINE JOB NO: 2025-1108

BY-LINE:
BY-LINE SURVYING LLC
 100 Beckham
 PO Box 1124
 Terrell, TX 75761
 Phone No. (940) 761-1124
 www.bylinesurveying.com

SCALE: 1" = 40'

TECHNICAL: ELOY MEDRANO



STEVEN MOODY ET AL
 1181 CROW LN
 TERRELL, TX 75761
 VOL. 3932, PG. 444
 O.P.R.C.C.T.

BOBBY ANGLIN, TRUSTEE
 FARM VIEW ESTATES
 CAB. 2, ENV. 275
 P.R.C.C.T.

ELVA CORONADO ET AL
 46471 AC.
 VOL. 4097, PG. 30
 O.P.R.C.C.T.

LOT 27
 2.00 ACRES

LOT 28
 2.00 ACRES

LOT 29
 1.58 ACRES

LOT 30
 1.58 ACRES

LOT 31
 1.58 ACRES

LINE	BEARING	DISTANCE	AREA
1	S88°52'55"W	589.14'	1.00 AC
2	S88°52'55"W	589.14'	1.00 AC
3	S88°52'55"W	589.14'	1.00 AC
4	S88°52'55"W	589.14'	1.00 AC
5	S88°52'55"W	589.14'	1.00 AC
6	S88°52'55"W	589.14'	1.00 AC
7	S88°52'55"W	589.14'	1.00 AC
8	S88°52'55"W	589.14'	1.00 AC
9	S88°52'55"W	589.14'	1.00 AC
10	S88°52'55"W	589.14'	1.00 AC
11	S88°52'55"W	589.14'	1.00 AC
12	S88°52'55"W	589.14'	1.00 AC
13	S88°52'55"W	589.14'	1.00 AC
14	S88°52'55"W	589.14'	1.00 AC
15	S88°52'55"W	589.14'	1.00 AC
16	S88°52'55"W	589.14'	1.00 AC
17	S88°52'55"W	589.14'	1.00 AC
18	S88°52'55"W	589.14'	1.00 AC
19	S88°52'55"W	589.14'	1.00 AC
20	S88°52'55"W	589.14'	1.00 AC
21	S88°52'55"W	589.14'	1.00 AC
22	S88°52'55"W	589.14'	1.00 AC
23	S88°52'55"W	589.14'	1.00 AC
24	S88°52'55"W	589.14'	1.00 AC
25	S88°52'55"W	589.14'	1.00 AC
26	S88°52'55"W	589.14'	1.00 AC
27	S88°52'55"W	589.14'	1.00 AC
28	S88°52'55"W	589.14'	1.00 AC
29	S88°52'55"W	589.14'	1.00 AC
30	S88°52'55"W	589.14'	1.00 AC
31	S88°52'55"W	589.14'	1.00 AC

KNOW ALL MEN BY THESE PRESENTS:
 That I, Eloy Medrano, as Registered Professional Land Surveyor, do hereby certify that I prepared this plat from an actual and accurate survey of the land and that the corner monuments shown hereon as set were properly placed under my personal supervision in accordance with the platting rules and regulations of Kaufman County, Texas.

WARRANTY DEED FOR ANY PART OF THIS PLAT
 A FULL SURVEY RECORD

TERO Y. HOPE
 Registered Professional Land Surveyor
 State of Texas No. 6746

NOTES:

1. Bearings based on Texas State Plane Coordinate, Texas North
2. The property is shown as being located in Flood Zone X by Flood Insurance Rate Map No. 48057Z02050 with an effective date of 08/01/2005. The property is shown as being located in a Special Flood Hazard Area as indicated by 100-year Flood.
3. Construction not completed within one year of the recording date of this plat.
4. The platting rules and regulations of Kaufman County, Texas, may require the submission to the recorded platting authority for approval.
5. The making, erecting or changing of monuments, including the platting and filling or obstruction of the roadway is prohibited.
6. The platting rules and regulations of Kaufman County, Texas, may require the submission to the recorded platting authority for approval.
7. The platting rules and regulations of Kaufman County, Texas, may require the submission to the recorded platting authority for approval.
8. The platting rules and regulations of Kaufman County, Texas, may require the submission to the recorded platting authority for approval.
9. The platting rules and regulations of Kaufman County, Texas, may require the submission to the recorded platting authority for approval.
10. The platting rules and regulations of Kaufman County, Texas, may require the submission to the recorded platting authority for approval.
11. The platting rules and regulations of Kaufman County, Texas, may require the submission to the recorded platting authority for approval.
12. The platting rules and regulations of Kaufman County, Texas, may require the submission to the recorded platting authority for approval.
13. The platting rules and regulations of Kaufman County, Texas, may require the submission to the recorded platting authority for approval.
14. The platting rules and regulations of Kaufman County, Texas, may require the submission to the recorded platting authority for approval.
15. The platting rules and regulations of Kaufman County, Texas, may require the submission to the recorded platting authority for approval.

KNOW ALL MEN BY THESE PRESENTS:
 That I, Eloy Medrano, as Registered Professional Land Surveyor, do hereby certify that I prepared this plat from an actual and accurate survey of the land and that the corner monuments shown hereon as set were properly placed under my personal supervision in accordance with the platting rules and regulations of Kaufman County, Texas.

WARRANTY DEED FOR ANY PART OF THIS PLAT
 A FULL SURVEY RECORD

TERO Y. HOPE
 Registered Professional Land Surveyor
 State of Texas No. 6746

NOTES:

1. Bearings based on Texas State Plane Coordinate, Texas North
2. The property is shown as being located in Flood Zone X by Flood Insurance Rate Map No. 48057Z02050 with an effective date of 08/01/2005. The property is shown as being located in a Special Flood Hazard Area as indicated by 100-year Flood.
3. Construction not completed within one year of the recording date of this plat.
4. The platting rules and regulations of Kaufman County, Texas, may require the submission to the recorded platting authority for approval.
5. The making, erecting or changing of monuments, including the platting and filling or obstruction of the roadway is prohibited.
6. The platting rules and regulations of Kaufman County, Texas, may require the submission to the recorded platting authority for approval.
7. The platting rules and regulations of Kaufman County, Texas, may require the submission to the recorded platting authority for approval.
8. The platting rules and regulations of Kaufman County, Texas, may require the submission to the recorded platting authority for approval.
9. The platting rules and regulations of Kaufman County, Texas, may require the submission to the recorded platting authority for approval.
10. The platting rules and regulations of Kaufman County, Texas, may require the submission to the recorded platting authority for approval.
11. The platting rules and regulations of Kaufman County, Texas, may require the submission to the recorded platting authority for approval.
12. The platting rules and regulations of Kaufman County, Texas, may require the submission to the recorded platting authority for approval.
13. The platting rules and regulations of Kaufman County, Texas, may require the submission to the recorded platting authority for approval.
14. The platting rules and regulations of Kaufman County, Texas, may require the submission to the recorded platting authority for approval.
15. The platting rules and regulations of Kaufman County, Texas, may require the submission to the recorded platting authority for approval.

KNOW ALL MEN BY THESE PRESENTS:
 That I, Eloy Medrano, as Registered Professional Land Surveyor, do hereby certify that I prepared this plat from an actual and accurate survey of the land and that the corner monuments shown hereon as set were properly placed under my personal supervision in accordance with the platting rules and regulations of Kaufman County, Texas.

WARRANTY DEED FOR ANY PART OF THIS PLAT
 A FULL SURVEY RECORD

TERO Y. HOPE
 Registered Professional Land Surveyor
 State of Texas No. 6746

KNOW ALL MEN BY THESE PRESENTS:
 That I, Eloy Medrano, as Registered Professional Land Surveyor, do hereby certify that I prepared this plat from an actual and accurate survey of the land and that the corner monuments shown hereon as set were properly placed under my personal supervision in accordance with the platting rules and regulations of Kaufman County, Texas.

WARRANTY DEED FOR ANY PART OF THIS PLAT
 A FULL SURVEY RECORD

TERO Y. HOPE
 Registered Professional Land Surveyor
 State of Texas No. 6746

KNOW ALL MEN BY THESE PRESENTS:
 That I, Eloy Medrano, as Registered Professional Land Surveyor, do hereby certify that I prepared this plat from an actual and accurate survey of the land and that the corner monuments shown hereon as set were properly placed under my personal supervision in accordance with the platting rules and regulations of Kaufman County, Texas.

WARRANTY DEED FOR ANY PART OF THIS PLAT
 A FULL SURVEY RECORD

TERO Y. HOPE
 Registered Professional Land Surveyor
 State of Texas No. 6746

KNOW ALL MEN BY THESE PRESENTS:
 That I, Eloy Medrano, as Registered Professional Land Surveyor, do hereby certify that I prepared this plat from an actual and accurate survey of the land and that the corner monuments shown hereon as set were properly placed under my personal supervision in accordance with the platting rules and regulations of Kaufman County, Texas.

WARRANTY DEED FOR ANY PART OF THIS PLAT
 A FULL SURVEY RECORD

TERO Y. HOPE
 Registered Professional Land Surveyor
 State of Texas No. 6746

KNOW ALL MEN BY THESE PRESENTS:
 That I, Eloy Medrano, as Registered Professional Land Surveyor, do hereby certify that I prepared this plat from an actual and accurate survey of the land and that the corner monuments shown hereon as set were properly placed under my personal supervision in accordance with the platting rules and regulations of Kaufman County, Texas.

WARRANTY DEED FOR ANY PART OF THIS PLAT
 A FULL SURVEY RECORD

TERO Y. HOPE
 Registered Professional Land Surveyor
 State of Texas No. 6746

KNOW ALL MEN BY THESE PRESENTS:
 That I, Eloy Medrano, as Registered Professional Land Surveyor, do hereby certify that I prepared this plat from an actual and accurate survey of the land and that the corner monuments shown hereon as set were properly placed under my personal supervision in accordance with the platting rules and regulations of Kaufman County, Texas.

WARRANTY DEED FOR ANY PART OF THIS PLAT
 A FULL SURVEY RECORD

TERO Y. HOPE
 Registered Professional Land Surveyor
 State of Texas No. 6746

**STATEWIDE SURVEYING SERVICES
REGISTERED PROFESSIONAL LAND SURVEYOR**

**GREG SJERVEN, R.P.L.S.
208 N. WASHINGTON**

KAUFMAN, TEXAS 75142

**www.statewidesurveyingservice.com
METRO PHONE: (972) 962-6481**

March 24, 2026

**Development Services Kaufman
106 W. Grove
Kaufman, Texas 75142
Attn: Monique Hunter
469-376-4751**

The plat of **Farm View Estates Lot 27R1 and 27R2** (dated 1.06.26) was checked and approved* by the County Surveyor of Kaufman County, Texas on this the 24th day of March, 2026.



Greg Sjerven, Registered Professional Surveyor No. 5244
County Surveyor of Kaufman County, Texas

**Owner: Eloy Medrano
1121 Crow Lane
Terrell, Texas 75161
214-878-9810**

**Surveyor: By-Line Surveying, LLC
P.O. Box 834
Emory, Texas 75440
903-473-5150**

*This plat approved in accordance with the subdivision regulations approved on Dec. 23, 2019, and amended Dec 9, 2025.



Kaufman County
Development Services

101 N. Houston St
Kaufman, TX 75142

To whom it may concern:

The Designated Representative of the Texas Commission of Environmental Quality (TCEQ), Jerry L. Martin (OS0034064) has reviewed the submitted Final Plat. Based on the information provided, the lot sizes appear to have met the minimum requirements and are in compliance with the Kaufman County OSSF Ordinance for the placement of any On-Site Sewage Facility (OSSF) on or at the identified locations:

Farm View Estates Replat of Lot 27; 2 LOTS (LOTS 27R1 & 27R2)

A handwritten signature in black ink, appearing to read "Jerry Martin", is written over a large, faint number "7".

Jerry Martin
Kaufman County DR
#0034064



Kaufman County
Development Services
101 N. Houston St
Kaufman, TX 75142
469-376-4127

November 19, 2025

Re: Lot 27 of Farm View Estates – PID 50778 – Final Plat - Floodplain

To whom it may concern:

Kaufman County, Development Services has reviewed this final plat and determined the area of **this plat does not contain a FEMA designated special flood hazard area (SFHA).** No Floodplain Development permit or Pre-Determination will be required.

Respectfully,

Jeremy Mungin

Jeremy Mungin
Kaufman County Engineer



www.tnpinc.com

engineers
surveyors
landscape architects

TEXAS
FORT WORTH
DENTON
ALLEN
SAN ANTONIO
CYPRESS
SUGAR LAND

GEORGIA
BLAIRSVILLE
ALBANY

March 26, 2026

Ms. Monique Hunter
Kaufman County – Development Services
101 N. Houston St.
Kaufman, TX 75142

**RE: Farm View Estates Lot 27 – Final Plat
Second Review**

Dear Ms. Hunter,

We have completed our review of the above-referenced project. Below are our comments on the final plat dated January 06, 2026 submitted by By-line Surveying, LLC on behalf of Eloy Medrano. All references to Articles shall be understood to refer to the Kaufman County Subdivision and Land Development Rules and Regulations (approved in December 2019 and amended in June 2024), unless otherwise noted.

Final Plat

1. Based upon our review, the Final Plat is in general conformance with the Kaufman County Subdivision and Land Development Rules and Regulations (approved in December 2019 and amended in June 2024).

Please let me know if you have any questions or if any of the above comments require clarification. If the developer, design engineer, or surveyor have any questions, they should be sent directly to Development Services.

Sincerely,
tnp
teague nall & perkins

Moksha Nedungadi, PE

Historical Commission
469-376-4140



3001 S. Washington
Kaufman, Texas 75142

November 24, 2025

Reference: Tract of Land Described

For: Medrano Eloy

REFERENCE:

Property described in the attached Exhibit "A"

I certify that to my knowledge this land/property has no historical significance; I permit this project to proceed. If cultural materials are encountered during construction work shall immediately cease in the area of discovery, and the Texas Historical Commission and the County of Kaufman shall be contacted.

Thank you,

A handwritten signature in cursive script that reads "Pam Corder".

Pam Corder
Kaufman County Historical Commission
3003 S. Washington Street
Kaufman, TX 75142

KAUFMAN COUNTY COMMISSIONERS' COURT AGENDA REQUEST FORM

Note: This form is required for agenda requests, with the exception of supporting materials or attachments. Forms should be returned to the County Judge's Office by email to Ashley.kirby@kaufmancounty.net and Kasey.hovis@kaufmancounty.net at the Justice Center located at 1902 US Hwy. 175, Kaufman, Texas, 75142 for inclusion on the court's agenda. Items will not be included if submitted after the deadline which is **Tuesday at 12:00 P.M (Noon)** preceding the court meeting. Items will also be omitted if no supporting documents are included with your request. Regular court meetings are held each Tuesday of the month.

COURT DATE REQUESTED: 6/9/26	SUBMITTED BY: Shannon Roden DEPARTMENT: Development Services	PERSON PRESENTING: Shannon Roden
--	---	--

ITEM REQUESTED IS FOR: <input type="radio"/> Consent Agenda <input checked="" type="radio"/> Action/Consideration <input type="radio"/> Discussion/Report <input type="radio"/> Executive Session <input type="radio"/> Public Workshop

ITEM: (PLEASE STATE EXACTLY AS YOU WANT TO APPEAR ON THE AGENDA) Discuss/Consider/Approve the Preliminary Replat of Ola Subdivision located on CR 106 in Precinct 1.
--



www.tnpinc.com

engineers
surveyors
landscape architects

TEXAS
FORT WORTH
DENTON
ALLEN
KATY
THE WOODLANDS
HOUSTON

May 28, 2026

Ms. Monique Hunter
Kaufman County – Development Services
101 N. Houston St.
Kaufman, TX 75142

**RE: Ola Subdivision – Preliminary Plat
First Review**

Dear Ms. Hunter,

We have completed our review of the above-referenced project. Below are our comments on the preliminary plat dated May 12, 2026 submitted by Hardin Surveying on behalf of Attainable Real Estate, LLC. All references to Articles shall be understood to refer to the Kaufman County Subdivision and Land Development Rules and Regulations (approved in December 2019 and amended in December 2025), unless otherwise noted.

Preliminary Plat

1. Based upon our review, the Preliminary Plat is in general conformance with the Kaufman County Subdivision and Land Development Rules and Regulations (approved in December 2019 and amended in December 2025). Approval of the Preliminary Plat shall allow the applicant to proceed with the development process by submitting Construction Plans as outlined in Article 4.02.J.
2. Approval of Preliminary Plat shall remain in effect for two years following the date of approval. If Construction Plans are not approved within two years, then approval of Preliminary Plat will expire per Article 4.02.K.

Please let me know if you have any questions or if any of the above comments require clarification. If the developer, design engineer, or surveyor have any questions, they should be sent directly to Development Services.

Sincerely,
tnp
teague nall & perkins

Moksha Nedungadi, PE

KAUFMAN COUNTY COMMISSIONERS' COURT AGENDA REQUEST FORM

Note: This form is required for agenda requests, with the exception of supporting materials or attachments. Forms should be returned to the County Judge's Office by email to Ashley.kirby@kaufmancounty.net and Kasey.hovis@kaufmancounty.net at the Justice Center located at 1902 US Hwy. 175, Kaufman, Texas, 75142 for inclusion on the court's agenda. Items will not be included if submitted after the deadline which is **Tuesday at 12:00 P.M (Noon)** preceding the court meeting. Items will also be omitted if no supporting documents are included with your request. Regular court meetings are held each Tuesday of the month.

COURT DATE REQUESTED: 6/9/26	SUBMITTED BY: Shannon Roden DEPARTMENT: Development Services	PERSON PRESENTING: Shannon Roden with Development Services
--	---	---

ITEM REQUESTED IS FOR: <input type="radio"/> Consent Agenda <input checked="" type="radio"/> Action/Consideration <input type="radio"/> Discussion/Report <input type="radio"/> Executive Session <input type="radio"/> Public Workshop

ITEM: (PLEASE STATE EXACTLY AS YOU WANT TO APPEAR ON THE AGENDA) Discuss/Consider/Approve the Preliminary Plat of Cory Morehead Subdivision #37 located on CR 4017 and FM 90 in Precinct 4.



www.tnpinc.com

engineers
surveyors
landscape architects

TEXAS
FORT WORTH
DENTON
ALLEN
CYPRESS
SUGAR LAND

May 28, 2026

Ms. Monique Hunter
Kaufman County – Development Services
101 N. Houston St.
Kaufman, TX 75142

**RE: Cory Morehead Subdivision #37 – Preliminary Plat
Fourth Review**

Dear Ms. Hunter,

We have completed our review of the above-referenced project. Below are our comments on the preliminary plat dated March 2, 2026 submitted by Hardin Surveying on behalf of Frontage Investments Inc. All references to Articles shall be understood to refer to the Kaufman County Subdivision and Land Development Rules and Regulations (approved in December 2019 and amended in December 2025), unless otherwise noted.

Preliminary Plat

1. Based upon our review, the Preliminary Plat is in general conformance with the Kaufman County Subdivision and Land Development Rules and Regulations (approved in December 2019 and amended in December 2025). Approval of the Preliminary Plat shall allow the applicant to proceed with the development process by submitting Construction Plans as outlined in Article 4.02.J.
2. Approval of Preliminary Plat shall remain in effect for two years following the date of approval. If Construction Plans are not approved within two years, then approval of Preliminary Plat will expire per Article 4.02.K.

Please let me know if you have any questions or if any of the above comments require clarification. If the developer, design engineer, or surveyor have any questions, they should be sent directly to Development Services.

Sincerely,
tnp
teague nall & perkins

Moksha Nedungadi, PE

TNP Firm  Registrations

TBPELS Engineering No. F-230 | Georgia Board of Professional Engineers, Firm No. PEF007431
TBPELS Surveying No. 10011600 | 10194381 | 10011601

PRELIMINARY PLAT

CORY MOREHEAD SUBDIVISION #37

18 LOTS
CREATING LOTS 1-18
64.150 ACRES (2794373 SQ. FT.)
T. DEVORE SURVEY, A-115
KAUFMAN COUNTY, TEXAS

JAMES DARGON
WESTBROOK
1.00 ACRE
1268 / 851

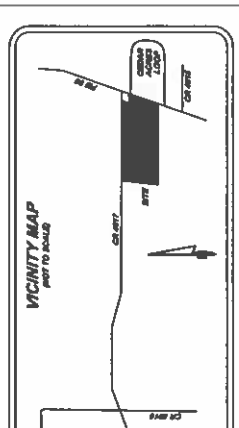

OWNER'S REPRESENTATION AND WARRANTY: THE OWNER OF THE ABOVE DESCRIBED PROPERTY, HEREBY WARRANTS AND AGREES TO DEFEND, INDEMNIFY AND HOLD HARMLESS THE CITY OF KAUFMAN, TEXAS, FROM ALL LIABILITY, DAMAGES, LOSSES AND EXPENSES, INCLUDING REASONABLE ATTORNEY'S FEES, THAT MAY BE INCURRED BY THE CITY OF KAUFMAN, TEXAS, AS A RESULT OF THE CITY OF KAUFMAN, TEXAS, APPROVING THIS PLAT AND THE CONSTRUCTION OF THE IMPROVEMENTS SHOWN THEREON.

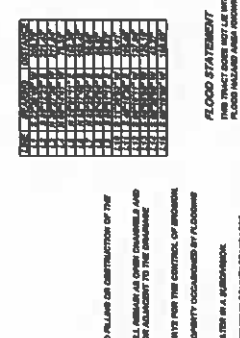
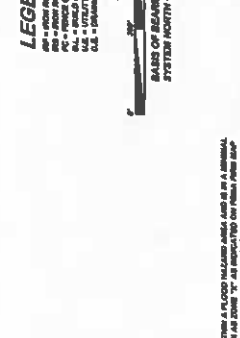
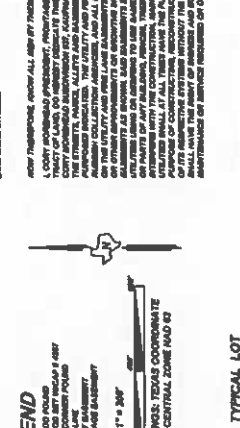
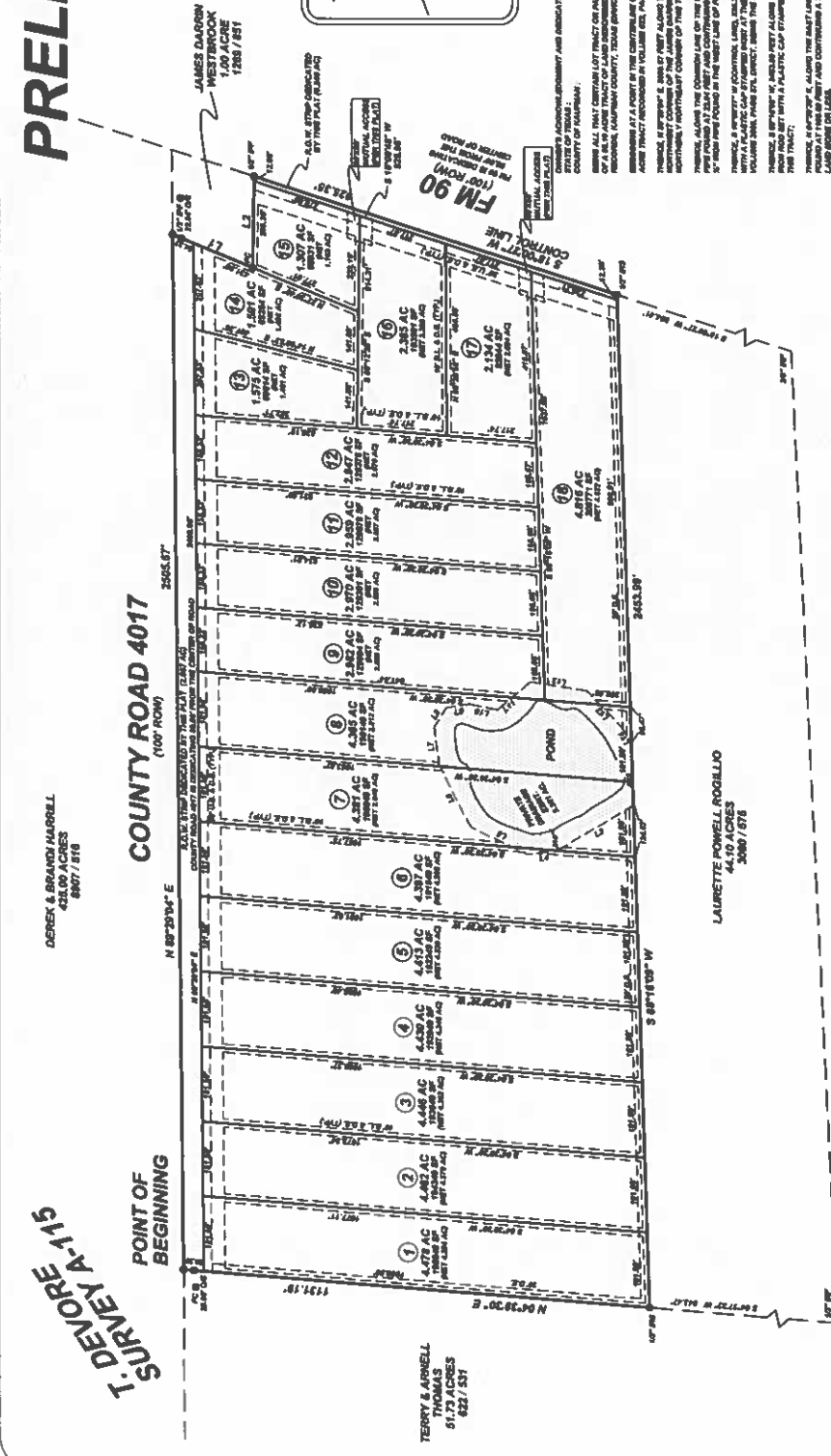

FLOOD STATEMENT
This plat is located within the 100-year flood zone as shown on the Flood Insurance Rate Map (FIRM) for Kaufman County, Texas, dated 7/7/2013, prepared by the Federal Emergency Management Agency (FEMA). The flood zone is shown in yellow on the FIRM. The owner of the property shown on this plat warrants that the property is not located in a flood zone.

OWNERS / DEVELOPERS INC.
PROFFAGE INVESTMENTS INC.
PO BOX 1213
HUNTINGTON, TEXAS 75849
(800) 801-8009
LANOWHY@GMAIL.COM

HARDING SURVEYING
201 E. MASON STREET
MABANK, TEXAS 75147
(903) 887-5874
FIRM# 10114700
DATE RECORDED: MARCH 2, 2015
DATE PREPARED: OCTOBER 4, 2014
SCALE: 1" = 100 FEET
DRAWN BY: BM

APPROVED BY THE COMMISSIONER OF KAUFMAN COUNTY, TEXAS, THIS THE _____ DAY OF _____, 2015.

COUNTY CLERK

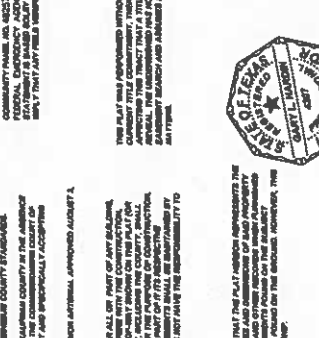

TERRY & ARNELL THOMAS
517.7 ACRES
622 / 537

LAURETTE POWELL ROGILLO
44.10 ACRES
3080 / 876

DENEY & BRANDI MARRELL
64.15 ACRES
4807 / 816

KAUFMAN COUNTY COMMISSIONERS' COURT AGENDA REQUEST FORM

Note: This form is required for agenda requests, with the exception of supporting materials or attachments. Forms should be returned to the County Judge's Office by email to Ashley.kirby@kaufmancounty.net and Kasey.hovis@kaufmancounty.net at the Justice Center located at 1902 US Hwy. 175, Kaufman, Texas, 75142 for inclusion on the court's agenda. Items will not be included if submitted after the deadline which is **Tuesday at 12:00 P.M (Noon)** preceding the court meeting. Items will also be omitted if no supporting documents are included with your request. Regular court meetings are held each Tuesday of the month.

COURT DATE REQUESTED: 6/9/26	SUBMITTED BY: Jeremy Mungin DEPARTMENT: Development Services	PERSON PRESENTING: Jeremy Mungin
--	---	--

ITEM REQUESTED IS FOR: <input type="radio"/> Consent Agenda <input checked="" type="radio"/> Action/Consideration <input type="radio"/> Discussion/Report <input type="radio"/> Executive Session <input type="radio"/> Public Workshop

ITEM: (PLEASE STATE EXACTLY AS YOU WANT TO APPEAR ON THE AGENDA) Discuss/Consider/ Approve fiber installation from Spectrum on County Road 136, County Road 137, Bradeen Dr, Crow Ln, and Anglin Way in Precinct 1
--



Kaufman County

106 W. Grove Street • Kaufman, Texas 75142 • (469) 376-4127 • www.kaufmancounty.net

SITE DEVELOPMENT AND PLAT APPLICATION FORM

All applications must be submitted with (1) a complete, (2) a completed application checklist, and (3) all materials listed in the appropriate checklist. The Development Services staff is available to assist you in person at the Kaufman County Development Services Department or by phone, please call 469-376-4127 for an appointment. Applications may be submitted at any time.

PROJECT NAME: PID 573866 Kaufman CR 136, Bradeen Dr, Crow Ln, Anglin Way, Kaufman CR 137

TYPE OF APPLICATION (Box 1 of 6)

Instructions: Please check the appropriate box(es) below.

SITE DEVELOPMENT AUTHORIZATION APPLICATIONS

- Floodplain Development Permit
- On-Site Sewage Facility (OSSF) Permit
- Manufactured Home Community and RV Park Permit
- Use of County Property (including driveway culverts)

SUBDIVISION RELATED APPLICATIONS

- Preliminary Plat
- Final Plat
- Amending Plat
- Cancellation of a Subdivision
- Revision of a Plat
- Platting Exception
- Utility Connection Certificate
- Preliminary 911 Addressing
- Final 911 Addressing

REGULATED LAND USES

- Automotive Wrecking & Salvage Yard
- Demolition Business
- Flea Market
- Junkyard
- Outdoor Resale Business
- Sexually Oriented Business

NOTICE AND INSPECTION

- Residential Building Notice and Inspection Requirement



Kaufman County

101 N. Houston Street · Kaufman, Texas 75142 · (469) 376-4127 · www.kaufmancounty.net · Publicworks@KaufmanCounty.net

APPLICANT INFORMATION (Bo. 2 of 6)	
Applicant Name: Richie Bonner	Company/Firm Name: Spectrum Gulf Coast
Address: 1565 Chenault St	
City/State/Zip: Dallas, TX 75228	
Contact Number Primary: 817-205-8177	Contact Number (Secondary):
Contact Email: richie.bonner@charter.com	
Applicant Signature: <i>Richie Bonner</i>	Date: 5/20/26

PROPERTY OWNER INFORMATION (Bo. 3 of 6)	
Applicant Name: Jerry Ringo	Company/Firm Name: Future
Address: 555 S Town East Blvd	
City/State/Zip: Mesquite, TX 75149	
Contact Number Primary: 469-260-3947	Contact Number (Secondary): 972-329-9933
Contact Email: jerry.ringo@prim.com	
Applicant Signature: <i>Jerry Ringo</i>	Date: 5/20/26

PROPERTY INFORMATION (Bo. 4 of 6)	
Project Name: PID 5738666	
Address: Kaufman CR 136, Bradeen Dr, Crow Ln, Anglin Way, Kaufman CR 137	
City/State/Zip: Kaufman	
Parcel Tax ID#:	



Kaufman County

106 W. Grove Street • Kaufman, Texas 75142 • (469) 376-4127 • www.kaufmancounty.net

PROPERTY OWNER CONSENT/ AGENT AUTHORIZATION (Bo. 5 of 6)

By my signature, I hereby affirm that I am the property owner of record, or if the applicant is an organization or business entity, that authorization has been granted to represent the owner, organization or business in this application. I certify that the preceding information is complete and accurate, and it is understood that I agree to the application being requested for this property. Additionally, my signature below indicates my awareness of the fee required at the time of the application submittal and any additional fees as noted in the County's fee schedule. This fee is non-refundable even in the event of application withdrawal. I have the power to authorize and hereby grant permission for Kaufman County officials to enter the property on official business as part of the application process.

Signature:

Clemon Maddox

Printed Name:

Clemon Maddox

Date: 5-22-2026

By signing this form, the owner of the property authorizes Kaufman County to begin proceeding in accordance with the process for the type of application indicated on this application. The owner further acknowledges that submission of an application does not in any way obligate the County to approve the application and that although County staff may make certain recommendations regarding this application, the decision making authority may not follow that recommendation and may make a final decision that does not conform to the staff's recommendation.

NOTARY (Bo. 6 of 6)

STATE OF TEXAS 5
COUNTY OF KAUFMAN

BEFORE ME, the undersigned authority in and for Tarrant County, Texas, on this day personally appeared Clemon Maddox, known to me to be the person and officer whose name is subscribed to the foregoing instrument and acknowledged to me that he/she is an authorized signatory he/she is authorized to execute the foregoing instrument for the purposes and consideration therein expressed, and in the capacity therein stated.

GIVEN UNDER MY HAND AND SEAL OF OFFICE, this the 22 day of May, 2026

[Signature]
Notary Public in and for the State of Texas

Daniel Fernandez
Type or Print Notary's Name

My Commission Expires: 01/01/2021





Kaufman County

106 W. Grove Street • Kaufman, Texas 75142 • (469) 376-4127 • www.kaufmancounty.net

Certification of Submitted Information

I hereby certify that the above stated information is included with the accompanying submission materials. Further, I have reviewed and met the standards contained in Section 11 (Development or Use of County Property or Facility) of the Kaufman County Subdivision and Land Development Regulations.

Jessie Hatley DFW Telecom

Applicant's Signature

5/20/26

Date

Verification of Detailed Information

I hereby confirm that the above detailed information as required by the checklist is complete and accurate to the best of my knowledge. I understand that proper County staff review of this application is dependent upon the accuracy of the information provided and that any inaccurate or inadequate information provided by me or my firm may delay the proper review of this application.

Applicant's Engineer's Signature

Spectrum Gulf Coast, LLC

Firm

Date



Sheet 1 of 4

NOTICE TO CONTRACTOR: TO MAINTAIN PROTECTIVE CURBS, DITCHES, STREETS, AND SIDEWAYS

Kaufman County Notes conduit shall be placed a minimum of 36" below the lowest point of the ditch or 60" below the top of pavement

Project consists of approximately 10,338' of Underground Fiber

GENERAL CONSTRUCTION NOTES

- 1. UNDERGROUND FIBER SHALL BE INSTALLED IN ACCORDANCE WITH THE REQUIREMENTS OF THE CONSTRUCTION CONTRACT AND THE SPECIFICATIONS TO MAINTAIN PROTECTIVE CURBS, DITCHES, STREETS, AND SIDEWAYS.
- 2. THE CONTRACTOR SHALL BE RESPONSIBLE FOR OBTAINING ALL NECESSARY PERMITS AND APPROVALS FROM ALL APPLICABLE AGENCIES AND AGENCIES.
- 3. THE CONTRACTOR SHALL BE RESPONSIBLE FOR OBTAINING ALL NECESSARY PERMITS AND APPROVALS FROM ALL APPLICABLE AGENCIES AND AGENCIES.
- 4. THE CONTRACTOR SHALL BE RESPONSIBLE FOR OBTAINING ALL NECESSARY PERMITS AND APPROVALS FROM ALL APPLICABLE AGENCIES AND AGENCIES.
- 5. THE CONTRACTOR SHALL BE RESPONSIBLE FOR OBTAINING ALL NECESSARY PERMITS AND APPROVALS FROM ALL APPLICABLE AGENCIES AND AGENCIES.
- 6. THE CONTRACTOR SHALL BE RESPONSIBLE FOR OBTAINING ALL NECESSARY PERMITS AND APPROVALS FROM ALL APPLICABLE AGENCIES AND AGENCIES.
- 7. THE CONTRACTOR SHALL BE RESPONSIBLE FOR OBTAINING ALL NECESSARY PERMITS AND APPROVALS FROM ALL APPLICABLE AGENCIES AND AGENCIES.
- 8. THE CONTRACTOR SHALL BE RESPONSIBLE FOR OBTAINING ALL NECESSARY PERMITS AND APPROVALS FROM ALL APPLICABLE AGENCIES AND AGENCIES.
- 9. THE CONTRACTOR SHALL BE RESPONSIBLE FOR OBTAINING ALL NECESSARY PERMITS AND APPROVALS FROM ALL APPLICABLE AGENCIES AND AGENCIES.
- 10. THE CONTRACTOR SHALL BE RESPONSIBLE FOR OBTAINING ALL NECESSARY PERMITS AND APPROVALS FROM ALL APPLICABLE AGENCIES AND AGENCIES.

PID 6738666
Overview



Legend
Underground

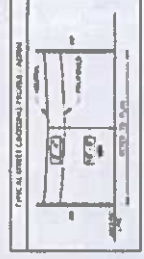
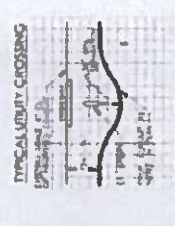

Google Earth

PREPARED BY DFW TELECOM, INC



NOTE:
CONTRACTOR IS RESPONSIBLE TO MAINTAIN TRAFFIC CONTROL, CONDUIT, DIRECT, STREET, SIDEWALK, AND SIDEWALKS.

Kaufman County Notes: conduit shall be placed a minimum of 36" below the lowest part of the ditch or 60" below the top of pavement.

Sheet 3 of 4

GENERAL CONSTRUCTION NOTES

1. ALL CONSTRUCTION SHALL BE IN ACCORDANCE WITH THE LATEST EDITION OF THE INTERNATIONAL CODE BOOKS, UNLESS OTHERWISE NOTED.
2. ALL CONSTRUCTION SHALL BE IN ACCORDANCE WITH THE LATEST EDITION OF THE INTERNATIONAL CODE BOOKS, UNLESS OTHERWISE NOTED.
3. ALL CONSTRUCTION SHALL BE IN ACCORDANCE WITH THE LATEST EDITION OF THE INTERNATIONAL CODE BOOKS, UNLESS OTHERWISE NOTED.
4. ALL CONSTRUCTION SHALL BE IN ACCORDANCE WITH THE LATEST EDITION OF THE INTERNATIONAL CODE BOOKS, UNLESS OTHERWISE NOTED.
5. ALL CONSTRUCTION SHALL BE IN ACCORDANCE WITH THE LATEST EDITION OF THE INTERNATIONAL CODE BOOKS, UNLESS OTHERWISE NOTED.
6. ALL CONSTRUCTION SHALL BE IN ACCORDANCE WITH THE LATEST EDITION OF THE INTERNATIONAL CODE BOOKS, UNLESS OTHERWISE NOTED.
7. ALL CONSTRUCTION SHALL BE IN ACCORDANCE WITH THE LATEST EDITION OF THE INTERNATIONAL CODE BOOKS, UNLESS OTHERWISE NOTED.
8. ALL CONSTRUCTION SHALL BE IN ACCORDANCE WITH THE LATEST EDITION OF THE INTERNATIONAL CODE BOOKS, UNLESS OTHERWISE NOTED.
9. ALL CONSTRUCTION SHALL BE IN ACCORDANCE WITH THE LATEST EDITION OF THE INTERNATIONAL CODE BOOKS, UNLESS OTHERWISE NOTED.
10. ALL CONSTRUCTION SHALL BE IN ACCORDANCE WITH THE LATEST EDITION OF THE INTERNATIONAL CODE BOOKS, UNLESS OTHERWISE NOTED.

PID 5738096
Overview

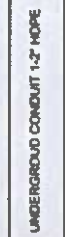
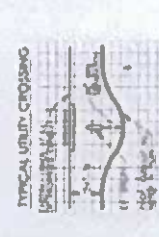

PREPARED BY DFW TELECOM, INC



NOTICE
CONTRACTOR IS RESPONSIBLE TO MAINTAIN ALL EXISTING UTILITIES
AS SHOWN ON THE PLAN AND TO PROTECT THEM FROM DAMAGE.

Kaufman County Notes: conduit shall be placed a minimum of 36" below the lowest point of the ditch or 60" below the top of pavement

Sheet 4 of 4

GENERAL CONSTRUCTION NOTES

1. Installation and backfilling shall be done in accordance with the specifications of the construction committee and shall include the following:
 - a. The trench shall be excavated to the required depth and width and shall be backfilled with the required material.
 - b. The trench shall be lined with the required material.
 - c. The trench shall be covered with the required material.
2. All conduit shall be placed with a minimum of 4" of sand under (depth to top of conduit).
3. The trench shall be covered with the required material and shall be finished to the original ground surface.
4. The contractor shall be responsible for the protection of all existing utilities and structures.
5. The contractor shall be responsible for the protection of all existing utilities and structures.
6. The contractor shall be responsible for the protection of all existing utilities and structures.
7. The contractor shall be responsible for the protection of all existing utilities and structures.
8. The contractor shall be responsible for the protection of all existing utilities and structures.
9. The contractor shall be responsible for the protection of all existing utilities and structures.
10. The contractor shall be responsible for the protection of all existing utilities and structures.



PID 573866
Overview

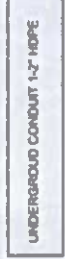
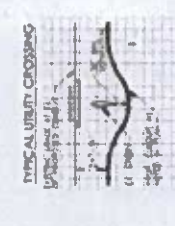

PREPARED BY DFW TELECOM, INC